

A

Standard Membranen, rund Round cones

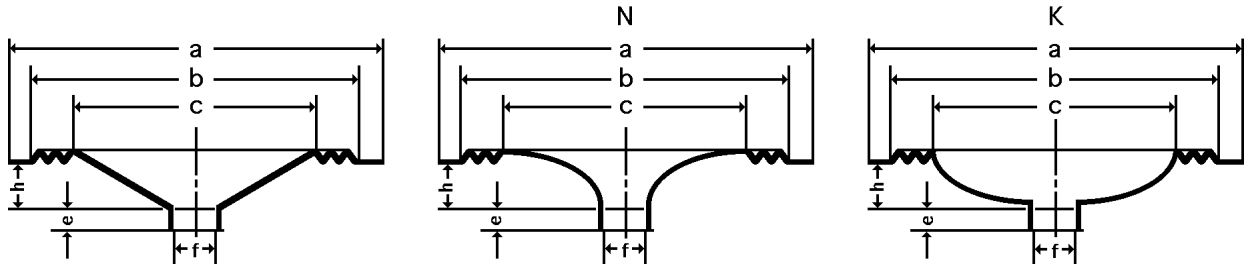

TYPE	Aussendurchmesser Outside diameter a mm inches	Rillen- ausenmass Outer diameter of groove b mm	Kegeldurch- messer Cone diameter c mm	Halsdurchmesser Neck diameter f mm inches	Höhe ohne Hals Height w/o neck h mm	Hals- höhe Neck height e mm	Form Form
------	---	--	--	--	--	--	--------------

Hals/Neck $\varnothing < 10$ mm

SMR 0351	48.0	1.89	41.0	35.0	2.0	0.079	6.2	0.0
SMR 0655	47.3	1.86	38.5	37.3	4.2	0.165	4.1	
SMR 0361	54.0	2.13	48.0	40.0	7.0	0.276	6.5	0.0
SMR 0362	65.0	2.56	57.4	47.4	7.0	0.276	6.8	
SMR 0355	75.0	2.95	67.4	55.9	7.0	0.276	7.3	
SMR 0360	98.0	3.86	90.0	75.0	8.2	0.323	10.5	
SMR 0627	47.0	1.85	42.8	36.6	9.5	0.374	3.1	0.0
SMR 0618	55.0	2.17	49.5	44.5	9.5	0.374	5.3	0.7

12 mm \leq Hals/Neck $\varnothing < 14$ mm

SMR 0372	96.0	3.78	89.0	67.2	12.0	0.472	13.5	2.5
SMR 0376	96.0	3.78	89.0	76.0	12.2	0.480	21.0	1.3
SMR 0788	66.0	2.60	61.4	57.0	12.3	0.482	14.2	0.5
SMR 0588	67.0	2.64	61.8	55.0	12.3	0.482	5.2	1.2
SMR 0613	55.0	2.17	49.5	44.5	12.3	0.484	5.7	3.0
SMR 0664	82.0	3.23	74.0	65.4	12.3	0.484	11.5	1.5
SMR 0750	97.0	3.82	89.0	79.0	12.3	0.484	27.5	1.5
SMR 0647	38.4	1.51	34.9	28.7	12.4	0.488	1.2	
SMR 0651	38.4	1.51	34.9	28.7	12.4	0.488	1.0	0.4
SMR 0636	43.0	1.69	39.0	32.8	12.4	0.488	4.5	1.0
SMR 0626	47.0	1.85	42.8	36.6	12.4	0.488	2.3	1.4
SMR 0762	54.5	2.15	47.0	45.6	12.4	0.488	9.1	0.5
SMR 0764	54.5	2.15	48.0	43.6	12.4	0.488	8.9	0.5
SMR 0805	54.5	2.15	48.0	41.5	12.4	0.488	8.0	0.5
SMR 0643	55.0	2.17	51.0	44.2	12.4	0.488	3.7	0.7
SMR 0756	66.0	2.60	61.2	57.0	12.4	0.488	14.2	0.5
SMR 0801	66.0	2.60	61.4	54.9	12.4	0.488	13.8	0.5
SMR 0783	82.0	3.23	74.0	65.4	12.4	0.488	14.0	1.0
SMR 0719	54.5	2.15	48.8	47.4	12.5	0.490	9.1	0.5
SMR 1012	96.0	3.78	90.3	75.5	12.5	0.490	15.4	1.0
SMR 0896	126.0	4.96	109.0	86.0	12.5	0.490	19.3	1.5

Materialien/Materials

Zellulose, Kunststoffe
Cellulose, plastics

Optionen/Options

luftgetrocknet, hartverpresst, Farbe
air dried, pressed, color

N = Nawi-Kegel / Nawi cone
K = Konvex-Kegel / Convex cone

A

Standard Membranen, rund Round cones

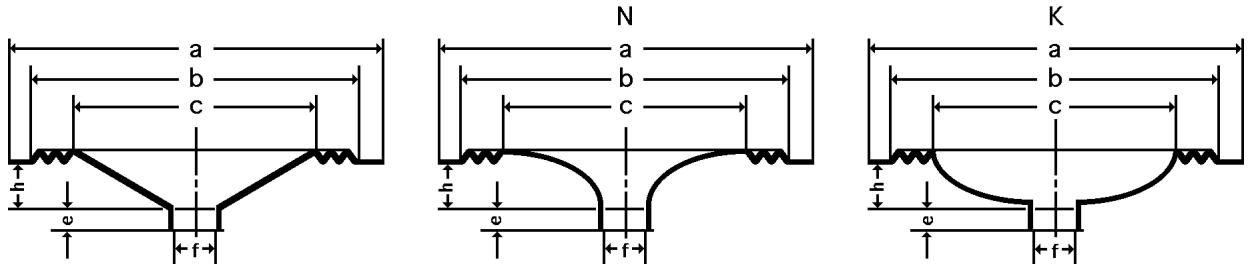

TYPE	Aussendurchmesser		Rillen-	Kegeldurch-	Halsdurchmesser		Höhe	Hals-	Form
	Outside diameter		aussenmass	durchmesser	Neck diameter		ohne Hals	höhe	
	a		Outer diameter of groove	Cone diameter	f		Height w/o neck	Neck height	Form
	mm	inches	b	c	mm	inches	h	e	
			mm	mm			mm	mm	

SMR 0612	47.0	1.85	43.0	37.6	12.5	0.492	2.4	1.0	
SMR 0590	55.0	2.17	49.5	44.5	12.5	0.492	5.7	0.7	
SMR 0354	62.0	2.44	56.0	47.0	12.5	0.492	8.5	1.5	
SMR 0688	69.0	2.72	62.0	53.0	12.5	0.492	9.8	1.2	
SMR 0696	83.0	3.27	78.0	65.2	12.5	0.492	10.5	1.0	
SMR 0583	100.0	3.94	91.0	73.0	12.5	0.492	15.0	2.0	
SMR 0607	111.0	4.37	99.0	91.4	12.5	0.492	20.3	1.0	
SMR 0501	97.0	3.82	89.0	79.0	12.6	0.496	24.4	1.5	
SMR 1078	54.5	2.15	48.8	41.8	12.7	0.500	9.1		
SMR 0364	63.0	2.48	50.5	48.5	12.7	0.500	1.7	1.0	
SMR 0369	84.5	3.33	75.0	65.0	12.7	0.500	11.8	2.0	
SMR 0660	84.5	3.33	78.5	67.5	12.7	0.500	16.5	1.0	
SMR 0663	100.0	3.94	93.0	79.8	12.7	0.500	15.0	1.5	
SMR 0851	48.0	1.89	45.0	38.8	12.8	0.504	1.9	0.3	
SMR 0757	75.0	2.95	70.0	60.0	12.8	0.504	5.0	1.0	
SMR 0333	63.0	2.48	56.0	46.0	12.9	0.508	3.9	1.0	
SMR 0334	63.0	2.48	56.0	46.0	12.9	0.508	20.0	1.5	
SMR 0353	63.0	2.48	56.0	46.0	12.9	0.508	9.4	1.0	
SMR 0885	63.0	2.48	58.4	50.0	13.7	0.539	3.3	1.5	

14 mm ≤ Hals/Neck ø < 16 mm

SMR 0363	65.0	2.56	56.0	45.9	14.1	0.555	7.3	2.0	
SMR 0597	68.0	2.68	62.6	54.0	14.1	0.555	5.0	1.0	
SMR 0615	68.0	2.68	62.6	54.0	14.1	0.555	5.0	1.0	
SMR 0610	68.0	2.68	64.4	56.0	14.1	0.555	5.0	1.0	
SMR 0604	70.0	2.76	52.6	48.0	14.1	0.555	8.0	1.0	
SMR 0628	55.4	2.18	50.8	44.0	14.2	0.559	3.7	0.5	
SMR 0573	67.0	2.64	61.8	55.0	14.2	0.559	5.0	1.2	
SMR 0784	68.0	2.68	62.6	53.4	14.5	0.571	4.0	0.5	
SMR 0749	100.0	3.94	91.0	73.0	14.6	0.575	15.0	1.0	
SMR 0870	100.0	3.94	92.6	75.6	14.6	0.575	7.7	0.8	
SMR 0768	74.0	2.91	68.9	58.0	14.7	0.579	5.7	1.0	
SMR 0865	74.0	2.91	69.0	58.0	14.7	0.579	5.5	1.0	

Materialien/Materials

Zellulose, Kunststoffe
Cellulose, plastics

Optionen/Options

luftgetrocknet, hartverpresst, Farbe
air dried, pressed, color

N = Nawi-Kegel / Nawi cone
K = Konvex-Kegel / Convex cone

A

Standard Membranen, rund Round cones

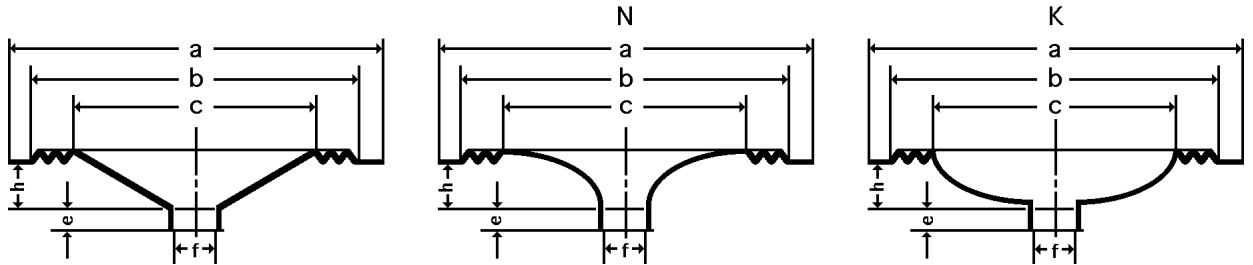

TYPE	Aussendurchmesser Outside diameter		Rillen- ausenmass Outer diameter of groove	Kegeldurch- messer Cone diameter	Halsdurchmesser Neck diameter		Höhe ohne Hals Height w/o neck	Hals- höhe Neck height	Form Form
	a		b	c	f		h	e	
	mm	inches	mm	mm	mm	inches	mm	mm	

SMR 0809	83.0	3.27	78.2	66.0	14.7	0.579	8.3	1.0	
SMR 0621	100.0	3.94	92.2	69.7	14.7	0.579	18.4	1.0	
SMR 0672	55.0	2.17	51.0	44.0	14.8	0.583	2.5	0.5	
SMR 0698	55.0	2.17	51.0	44.0	14.8	0.583	3.0	0.5	
SMR 0682	67.0	2.64	62.6	53.8	14.8	0.583	5.0	1.0	
SMR 0895	83.0	3.27	77.0	65.0	14.8	0.583	10.0	1.3	
SMR 0575	83.0	3.27	78.0	65.2	14.8	0.583	11.0	1.0	
SMR 0692	83.0	3.27	78.0	65.2	14.8	0.583	11.0	1.0	
SMR 0711	83.0	3.27	78.0	68.4	14.8	0.583	17.0	1.0	
SMR 0697	100.0	3.94	93.0	79.0	14.8	0.583	16.0	1.0	
SMR 0776	84.2	3.31	75.4	60.1	14.9	0.585	11.2	0.5	
SMR 0789	55.0	2.17	50.0	42.0	14.9	0.587	3.0	1.0	
SMR 0765	74.0	2.91	68.0	58.0	14.9	0.587	5.0	1.0	
SMR 0799	68.0	2.68	62.0	52.4	15.0	0.591	4.5	1.0	
SMR 0699	68.0	2.68	63.0	55.0	15.0	0.591	4.0	1.0	
SMR 0742	68.0	2.68	63.0	54.0	15.0	0.591	4.0	1.0	
SMR 0828	74.0	2.91	68.0	57.0	15.0	0.591	5.5	1.0	
SMR 0705	75.0	2.95	70.0	61.8	15.0	0.591	5.0	1.0	
SMR 0738	75.0	2.95	70.0	61.0	15.0	0.591	5.0	1.0	
SMR 0780	83.0	3.27	76.0	64.0	15.0	0.591	7.0	1.0	
SMR 0819	83.0	3.27	76.0	63.0	15.0	0.591	7.5	1.0	
SMR 0725	83.0	3.27	78.0	69.0	15.0	0.591	7.0	1.0	
SMR 0737	83.0	3.27	78.0	64.0	15.0	0.591	11.0	1.0	
SMR 0739	83.0	3.27	78.0	67.0	15.0	0.591	7.0	1.0	
SMR 0820	100.0	3.94	92.0	78.0	15.0	0.591	12.0	1.0	
SMR 0723	100.0	3.94	94.0	79.0	15.0	0.591	12.0	1.0	
SMR 0724	100.0	3.94	94.0	84.0	15.0	0.591	9.0	1.0	
SMR 0740	100.0	3.94	94.0	65.0	15.0	0.591	12.0	1.0	
SMR 0741	100.0	3.94	94.0	70.0	15.0	0.591	9.0	1.0	
SMR 0753	100.0	3.94	94.0	65.0	15.0	0.591	16.0	1.0	
SMR 0561	122.0	4.80	109.0	88.0	15.0	0.591	17.5	1.0	
SMR 0911	122.0	4.80	109.0	89.0	15.0	0.591	17.5	1.0	
SMR 0821	122.0	4.80	110.0	94.0	15.0	0.591	20.0	1.0	
SMR 0510	160.0	6.30	138.0	113.0	15.0	0.591	29.0	1.0	

Materialien/Materials

Zellulose, Kunststoffe
Cellulose, plastics

Optionen/Options

luftgetrocknet, hartverpresst, Farbe
air dried, pressed, color

N = Nawi-Kegel / Nawi cone
K = Konvex-Kegel / Convex cone

A

Standard Membranen, rund Round cones

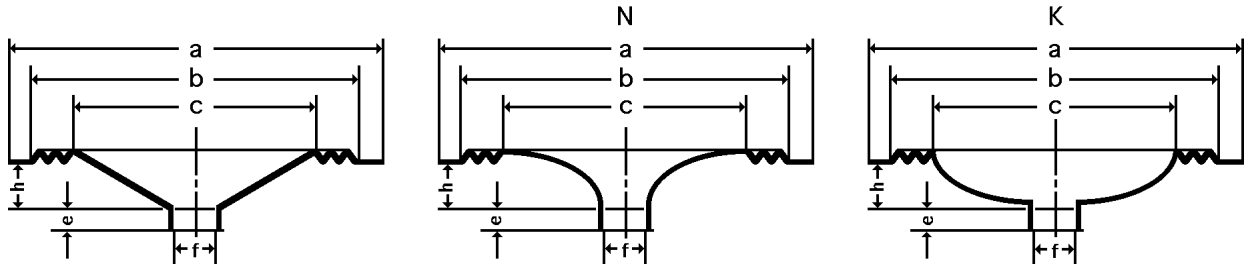

TYPE	Aussendurchmesser		Rillen-	Kegeldurch-	Halsdurchmesser		Höhe	Hals-	Form
	Outside diameter		aussenmass	durchmesser	Neck diameter		ohne Hals	höhe	
	a		Outer diameter	Cone	Neck diameter		Height	Neck	Form
	mm	inches	of groove	diameter	f		w/o neck	height	
	a		b	c	f		h	e	
	mm	inches	mm	mm	mm	inches	mm	mm	

SMR 0562	160.0	6.30	138.0	112.8	15.0	0.591	25.5	0.5	
SMR 0770	75.5	2.97	72.0	60.0	15.2	0.598	6.5	0.5	
SMR 0835	85.0	3.35	75.0	66.0	15.2	0.598	12.0	1.0	
SMR 0797	160.0	6.30	145.0	125.0	15.2	0.598	27.8	1.0	
SMR 1037	63.0	2.48	56.0	47.6	15.3	0.602	4.5	0.5	
SMR 0811	157.0	6.18	141.0	122.0	15.3	0.602	27.5	1.0	
SMR 0531	158.0	6.22	148.0	123.2	15.3	0.602	25.5	0.5	
SMR 0814	97.0	3.82	89.0	79.0	15.6	0.614	26.0	1.0	
SMR 0505	97.0	3.82	90.0	79.0	15.8	0.622	11.9	0.6	
SMR 0415	157.0	6.18	146.0	121.0	15.8	0.622	26.0	1.5	
SMR 0525	157.0	6.18	146.0	131.0	15.8	0.622	25.8	1.0	

16 mm ≤ Hals/Neck ø < 18 mm

SMR 0509	125.0	4.92	105.0	84.0	16.0	0.630	19.0	1.0	
SMR 0731	97.0	3.82	90.0	79.0	16.4	0.646	11.9	0.6	
SMR 0844	76.0	2.99	70.0	62.0	16.5	0.650	11.4	1.0	
SMR 0877	84.5	3.33	75.0	62.6	16.5	0.650	13.5	1.5	
SMR 0912	84.5	3.33	75.0	62.6	16.5	0.650	13.5	1.5	
SMR 0357	92.0	3.62	83.0	71.0	16.5	0.650	17.0	2.0	
SMR 0654	111.0	4.37	99.0	91.4	16.5	0.650	18.7	1.5	
SMR 1081	125.2	4.93	119.5	104.4	16.5	0.650	18.9	1.0	
SMR 0513	158.0	6.22	148.0	123.3	16.5	0.650	26.0	2.0	
SMR 0722	77.0	3.03	70.0	59.9	16.6	0.654	13.0	1.5	
SMR 0667	82.0	3.23	72.5	61.5	16.6	0.654	13.0	2.0	
SMR 0863	83.0	3.27	79.0	69.0	16.6	0.654	9.5	0.8	
SMR 0367	84.5	3.33	72.5	61.5	16.6	0.654	13.0	2.0	
SMR 0579	84.5	3.33	73.0	65.0	16.6	0.654	12.5	2.0	
SMR 0374	100.0	3.94	88.0	73.9	16.6	0.654	20.5	1.5	
SMR 0375	100.0	3.94	88.0	75.0	16.6	0.654	19.0	1.5	
SMR 0517	100.0	3.94	91.0	73.0	16.6	0.654	15.0	1.0	
SMR 0567	112.0	4.41	102.0	88.0	16.6	0.654	15.0	2.0	
SMR 0686	112.0	4.41	102.0	88.0	16.6	0.654	15.0	2.0	
SMR 0620	126.0	4.96	110.0	89.0	16.6	0.654	16.0	2.0	

Materialien/Materials

Zellulose, Kunststoffe
Cellulose, plastics

Optionen/Options

luftgetrocknet, hartverpresst, Farbe
air dried, pressed, color

N = Nawi-Kegel / Nawi cone
K = Konvex-Kegel / Convex cone

A

Standard Membranen, rund Round cones

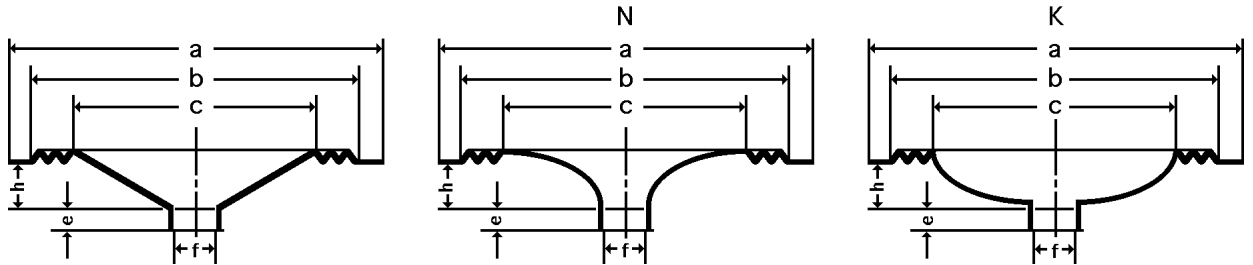

TYPE	Aussendurchmesser		Rillen-	Kegeldurch-	Halsdurchmesser		Höhe	Hals-	Form
	Outside diameter		aussenmass	durchmesser	Neck diameter		ohne Hals	höhe	
	a		Outer diameter of groove	Outer diameter of groove	Cone diameter	Neck diameter		Height w/o neck	Neck height
	mm	inches	b	c	f	f	h	e	Form
			mm	mm	mm	mm	mm	mm	

SMR 0365	84.5	3.33	70.0	61.6	16.7	0.657	13.0	2.0	
SMR 0366	84.5	3.33	75.5	61.5	16.7	0.657	13.0	2.0	
SMR 0657	97.0	3.82	91.0	77.6	16.7	0.657	11.9	1.0	
SMR 0616	102.0	4.02	94.0	81.0	16.7	0.657	11.9	1.7	
SMR 0653	102.0	4.02	94.0	80.6	16.7	0.657	11.9	1.7	
SMR 0910	120.0	4.72	110.0	94.0	16.7	0.657	23.3	2.0	
SMR 0576	121.0	4.76	107.2	94.0	16.7	0.657	19.8	2.0	
SMR 0582	121.0	4.76	107.2	94.0	16.7	0.657	19.8	2.0	
SMR 0920	122.0	4.80	109.0	88.0	16.7	0.657	17.5	1.0	
SMR 0833	100.0	3.94	92.0	78.6	16.8	0.661	12.0	1.0	
SMR 0416	126.0	4.96	110.0	89.0	16.8	0.661	20.0	1.0	
SMR 0595	144.0	5.67	126.0	111.0	16.8	0.661	38.9	1.5	
SMR 0634	163.0	6.42	150.0	125.0	16.8	0.661	26.5	1.5	
SMR 0834	122.0	4.80	110.0	94.0	17.0	0.669	20.0	1.0	
SMR 0822	102.0	4.02	99.0	76.6	17.6	0.693	10.0	1.0	

18 mm ≤ Hals/Neck ø < 20 mm

SMR 0875	82.0	3.23	74.0	65.0	19.4	0.764	13.5	1.5	
SMR 0929	103.0	4.06	93.0	81.8	19.5	0.768	19.0	1.5	
SMR 0673	97.0	3.82	87.4	76.2	19.6	0.772	13.4	1.5	
SMR 0852	101.0	3.98	88.0	75.5	19.6	0.772	17.9	1.5	
SMR 0975	120.0	4.72	110.0	94.0	19.6	0.772	23.3	2.0	
SMR 1076	120.0	4.72	110.0	93.5	19.6	0.772	11.5	1.5	
SMR 0991	120.0	4.72	112.0	92.8	19.6	0.772	23.3	2.0	
SMR 0381	124.0	4.88	110.0	92.8	19.6	0.772	20.9	2.0	
SMR 0414	125.0	4.92	115.0	97.0	19.6	0.772	20.5	1.5	
SMR 0385	126.0	4.96	110.0	89.0	19.6	0.772	18.5	3.0	
SMR 0388	155.0	6.10	141.0	116.0	19.6	0.772	26.0	2.0	
SMR 0536	155.0	6.10	141.0	111.6	19.6	0.772	26.0	2.0	
SMR 0758	155.0	6.10	141.0	118.9	19.6	0.772	28.0	2.0	
SMR 0867	162.0	6.38	145.6	124.8	19.6	0.772	19.0	1.0	
SMR 0393	174.0	6.85	161.0	136.0	19.6	0.772	27.0	1.5	
SMR 0496	175.0	6.89	167.0	142.0	19.6	0.772	40.5	2.0	

Materialien/Materials

Zellulose, Kunststoffe
Cellulose, plastics

Optionen/Options

luftgetrocknet, hartverpresst, Farbe
air dried, pressed, color

N = Nawi-Kegel / Nawi cone
K = Konvex-Kegel / Convex cone

A

Standard Membranen, rund Round cones

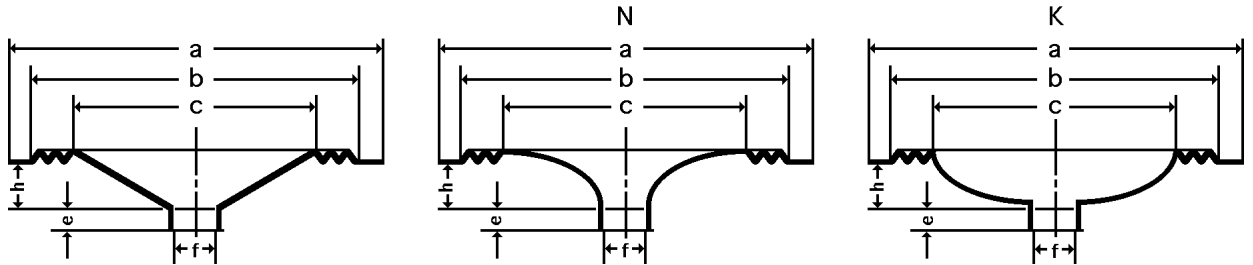

TYPE	Aussendurchmesser		Rillen-	Kegeldurch-	Halsdurchmesser		Höhe	Hals-	Form
	Outside diameter		aussenmass	durchmesser	Neck diameter		ohne Hals	höhe	
	a		Outer diameter of groove	Cone diameter	f		Height w/o neck	Neck height	Form
	mm	inches	b	c	mm	inches	h	e	
			mm	mm			mm	mm	

SMR 0396	178.0	7.01	160.0	139.0	19.6	0.772	35.9	2.0	
SMR 0707	196.0	7.72	183.0	166.4	19.6	0.772	38.0	2.5	
SMR 0448	207.0	8.15	191.0	163.0	19.6	0.772	40.0	2.5	
SMR 1040	83.0	3.27	72.0	61.7	19.7	0.776	13.0	1.5	
SMR 0359	96.0	3.78	89.0	68.8	19.7	0.776	13.0	3.0	
SMR 0862	96.0	3.78	90.0	79.0	19.7	0.776	13.2	2.0	
SMR 0893	96.0	3.78	90.0	79.2	19.7	0.776	13.2	1.5	
SMR 0379	100.0	3.94	85.0	69.0	19.7	0.776	15.0	2.0	
SMR 0409	125.0	4.92	118.0	84.6	19.7	0.776	27.0	2.0	
SMR 0383	126.0	4.96	104.5	89.3	19.7	0.776	20.9	2.0	
SMR 0382	126.0	4.96	107.2	94.0	19.7	0.776	18.5	2.0	
SMR 0813	126.0	4.96	107.2	94.0	19.7	0.776	18.5	2.0	
SMR 0384	126.0	4.96	110.0	98.0	19.7	0.776	18.6	2.0	
SMR 0440	126.0	4.96	110.0	89.0	19.7	0.776	18.5	3.0	
SMR 0528	126.0	4.96	112.0	95.6	19.7	0.776	18.5	2.0	
SMR 0533	126.0	4.96	112.0	93.2	19.7	0.776	18.5	2.0	
SMR 0942	126.0	4.96	115.0	97.0	19.7	0.776	19.4	0.5	
SMR 0387	147.0	5.79	139.0	120.0	19.7	0.776	20.9	1.5	
SMR 1011	154.0	6.06	140.0	118.4	19.7	0.776	34.5	2.0	
SMR 0889	162.0	6.38	150.0	125.4	19.7	0.776	27.2	1.0	
SMR 0439	173.0	6.81	153.5	127.1	19.7	0.776	33.0	2.0	
SMR 0420	174.0	6.85	163.0	139.0	19.7	0.776	35.5	2.0	
SMR 0432	175.0	6.89	167.0	138.8	19.7	0.776	40.0	2.0	
SMR 0433	175.0	6.89	167.0	132.2	19.7	0.776	40.0	2.0	
SMR 0485	175.0	6.89	168.0	136.8	19.7	0.776	42.0	2.5	
SMR 0398	179.0	7.05	164.0	140.0	19.7	0.776	43.9	2.5	
SMR 0410	192.0	7.56	174.0	152.0	19.7	0.776	43.0	2.0	
SMR 0447	195.0	7.68	179.0	151.0	19.7	0.776	37.0	2.5	
SMR 0401	196.0	7.72	174.0	152.0	19.7	0.776	42.0	2.5	
SMR 0514	196.0	7.72	180.0	150.0	19.7	0.776	44.0	2.0	
SMR 0519	196.0	7.72	180.0	153.0	19.7	0.776	44.0	2.0	
SMR 0516	198.0	7.80	178.0	150.0	19.7	0.776	39.0	1.5	
SMR 0500	204.0	8.03	185.0	159.0	19.7	0.776	54.0	3.0	
SMR 0550	204.0	8.03	185.0	151.6	19.7	0.776	39.0	3.0	

Materialien/Materials

Zellulose, Kunststoffe
Cellulose, plastics

Optionen/Options

luftgetrocknet, hartverpresst, Farbe
air dried, pressed, color

N = Nawi-Kegel / Nawi cone
K = Konvex-Kegel / Convex cone

A

Standard Membranen, rund Round cones

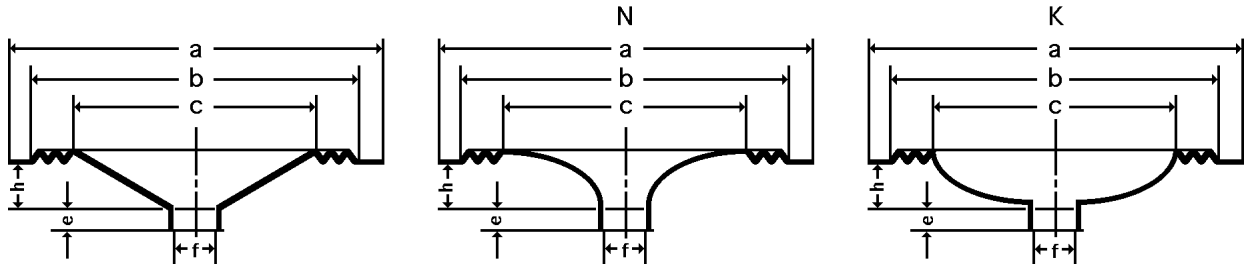

TYPE	Aussendurchmesser		Rillen-	Kegeldurch-	Halsdurchmesser		Höhe	Hals-	Form
	Outside diameter		aussenmass	durchmesser	Neck diameter		ohne Hals	höhe	
	a		Outer diameter of groove	Cone diameter	f		Height w/o neck	Neck height	Form
	mm	inches	b	c	mm	inches	h	e	
			mm	mm			mm	mm	

SMR 0958	83.0	3.27	75.5	63.6	19.8	0.780	10.0	1.5	
SMR 0378	100.0	3.94	88.0	68.0	19.8	0.780	13.3	2.0	
SMR 0380	101.0	3.98	92.0	79.0	19.8	0.780	11.5	2.0	
SMR 0412	123.0	4.84	104.7	90.8	19.8	0.780	18.5	2.5	
SMR 1051	129.0	5.08	117.0	96.0	19.8	0.780	28.5	0.5	
SMR 0700	162.5	6.40	147.5	125.1	19.8	0.780	15.0	1.2	
SMR 0389	170.0	6.69	150.0	131.0	19.8	0.780	31.0	2.0	
SMR 0549	171.5	6.75	158.0	135.2	19.8	0.780	33.0	2.5	
SMR 0527	171.5	6.75	160.0	135.0	19.8	0.780	33.0	2.0	
SMR 0419	174.0	6.85	160.0	137.0	19.8	0.780	33.0	2.5	
SMR 0546	174.0	6.85	160.0	134.6	19.8	0.780	33.0	2.5	
SMR 0631	174.0	6.85	160.0	135.0	19.8	0.780	30.0	1.0	
SMR 0391	174.0	6.85	163.0	142.0	19.8	0.780	35.5	2.0	
SMR 0392	174.0	6.85	163.0	145.0	19.8	0.780	35.5	2.0	
SMR 0422	181.0	7.13	165.0	141.0	19.8	0.780	33.0	2.0	
SMR 0426	210.0	8.27	190.0	168.0	19.8	0.780	38.0	2.0	
SMR 0390	171.0	6.73	152.8	132.0	19.9	0.783	33.0	2.0	

20 mm ≤ Hals/Neck ø < 25 mm

SMR 0718	132.0	5.20	123.0	106.0	20.0	0.787	18.5		
SMR 0760	156.0	6.14	146.0	118.0	20.4	0.803	31.0	0.5	
SMR 0713	157.0	6.18	146.0	126.0	22.4	0.882	25.3	1.5	

25 mm ≤ Hals/Neck ø < 30 mm

SMR 0443	210.0	8.27	194.0	166.0	25.4	1.000	38.0	2.5	
SMR 0430	236.0	9.29	211.0	185.0	25.4	1.000	65.5	5.0	
SMR 0405	210.0	8.27	186.0	165.0	25.5	1.004	53.3	3.0	
SMR 0841	144.0	5.67	126.0	111.0	25.6	1.008	35.0	1.5	
SMR 0842	144.0	5.67	126.0	111.0	25.6	1.008	35.0	1.5	
SMR 0424	195.0	7.68	179.0	151.0	25.7	1.012	35.0	2.5	
SMR 0442	207.0	8.15	191.0	163.0	25.7	1.012	38.0	2.5	
SMR 0423	181.0	7.13	165.0	142.0	25.8	1.016	33.0	2.0	
SMR 0961	196.0	7.72	174.0	152.0	25.8	1.016	40.5	2.5	

Materialien/Materials

Zellulose, Kunststoffe
Cellulose, plastics

Optionen/Options

luftgetrocknet, hartverpresst, Farbe
air dried, pressed, color

N = Nawi-Kegel / Nawi cone
K = Konvex-Kegel / Convex cone

A

Standard Membranen, rund Round cones

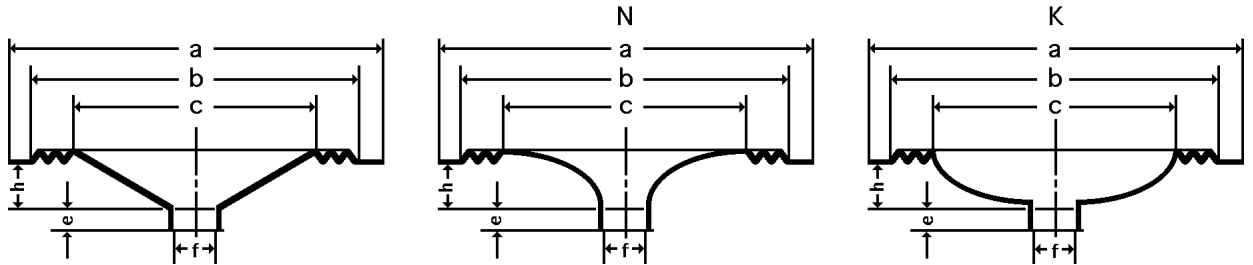

TYPE	Aussendurchmesser		Rillen-	Kegeldurch-	Halsdurchmesser		Höhe	Hals-	Form
	Outside diameter		aussenmass	durchmesser	Neck diameter		ohne Hals	höhe	
	a		Outer diameter	Cone	Neck diameter		Height	Neck	Form
	mm	inches	b	c	mm	inches	h	e	
			mm	mm	mm	mm	mm	mm	

SMR 1019	196.0	7.72	180.0	161.4	25.8	1.016	40.5	2.0	
SMR 0404	207.0	8.15	190.0	170.0	25.8	1.016	55.5	3.0	
SMR 0427	210.0	8.27	193.0	165.0	25.8	1.016	26.0	2.5	
SMR 0532	264.0	10.39	244.0	208.0	25.8	1.016	70.0	3.0	
SMR 0900	296.0	11.65	275.0	240.0	25.8	1.016	80.5	3.0	
SMR 0437	204.0	8.03	185.0	159.0	25.9	1.018	54.0	3.0	
SMR 0400	192.0	7.56	174.0	152.0	25.9	1.020	50.6	2.0	
SMR 0403	198.0	7.80	178.0	156.0	25.9	1.020	50.5	2.0	
SMR 0428	210.0	8.27	190.0	168.0	25.9	1.020	53.5	2.5	
SMR 0406	212.0	8.35	196.0	166.0	26.0	1.024	52.0	3.0	
SMR 0397	178.0	7.01	160.0	139.0	26.1	1.028	33.0	2.0	
SMR 0399	191.0	7.52	174.0	150.0	26.1	1.028	42.5	2.0	
SMR 0407	213.0	8.39	194.0	170.0	26.1	1.028	47.5	2.5	
SMR 0429	213.0	8.39	197.0	170.0	26.1	1.028	47.5	2.5	
SMR 0658	219.0	8.62	195.0	175.0	26.4	1.039	53.0	2.0	
SMR 0892	219.0	8.62	195.0	172.0	26.4	1.039	46.4	2.0	
SMR 0846	246.0	9.69	224.0	188.0	26.4	1.039	59.5	2.0	
SMR 0444	218.0	8.58	196.0	170.0	26.6	1.047	46.1	2.6	
SMR 0761	156.0	6.14	146.0	118.0	27.7	1.091	29.3	0.8	
SMR 0345	239.0	9.41	220.0	186.0	27.7	1.091	47.0	3.0	
SMR 0445	238.0	9.37	220.0	190.0	27.8	1.094	35.0	5.0	
SMR 0435	238.0	9.37	211.0	185.0	28.6	1.126	64.0	3.0	
SMR 0436	238.0	9.37	211.0	177.3	28.6	1.126	64.0	3.0	

30 mm ≤ Hals/Neck ø < 35 mm

SMR 0450	392.0	15.43	275.0	240.0	30.0	1.181	78.0	3.0	
SMR 0434	236.0	9.29	211.0	185.0	30.5	1.201	63.3	3.7	
SMR 0446	238.0	9.37	220.0	190.0	30.8	1.213	35.0	5.0	
SMR 0431	238.0	9.37	211.0	184.0	30.9	1.217	64.0	3.0	

35 mm ≤ Hals/Neck ø < 40 mm

SMR 0408	294.0	11.57	268.0	230.0	35.2	1.386	62.7	2.8	
SMR 0827	295.0	11.61	270.0	234.1	37.8	1.488	78.5	2.0	

Materialien/Materials

Zellulose, Kunststoffe
Cellulose, plastics

Optionen/Options

luftgetrocknet, hartverpresst, Farbe
air dried, pressed, color

N = Nawi-Kegel / Nawi cone
K = Konvex-Kegel / Convex cone

A

Standard Membranen, rund Round cones

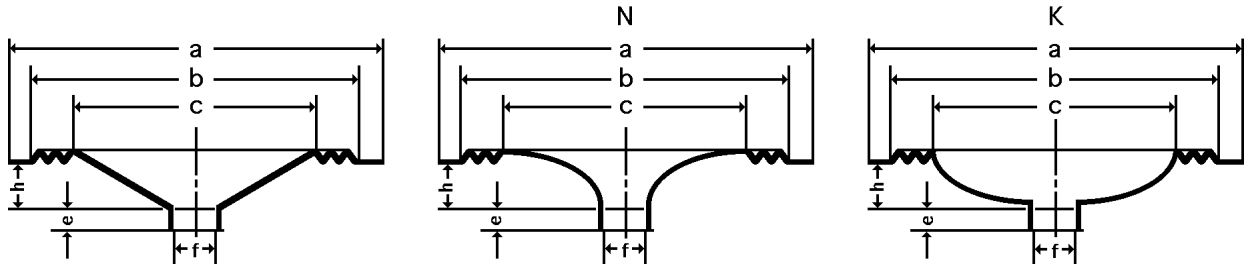

TYPE	Aussendurchmesser		Rillen-	Kegeldurch-	Halsdurchmesser		Höhe	Hals-	Form
	Outside diameter		aussenmass	durchmesser	Neck diameter		ohne Hals	höhe	
	a		b	c	f		h	e	
	mm	inches	mm	mm	mm	inches	mm	mm	

SMR 0919	295.0	11.61	272.0	241.0	37.8	1.488	78.5	3.5	
SMR 0906	335.0	13.19	318.0	286.0	37.8	1.488	75.0	4.0	
SMR 0438	295.0	11.61	270.0	230.0	37.9	1.492	78.5	2.0	
SMR 0854	295.0	11.61	270.0	232.4	37.9	1.492	78.5	4.5	
SMR 0871	295.0	11.61	270.0	230.0	38.1	1.500	78.5	4.5	
SMR 0830	375.0	14.76	345.0	309.0	38.4	1.512	100.0	2.0	
SMR 0847	246.0	9.69	224.0	188.0	38.8	1.528	59.5	2.0	

40 mm ≤ Hals/Neck ø < 50 mm

SMR 0845	305.0	12.01	273.4	240.0	45.0	1.772	78.0	3.0	
----------	-------	-------	-------	-------	------	-------	------	-----	--

Hals/Neck ø ≥ 50mm

SMR 1067	124.0	4.88	118.0	99.0	50.8	2.000	10.0	1.0	
SMR 0816	294.0	11.57	270.0	245.0	52.0	2.047	70.0	2.0	
SMR 0927	370.0	14.57	348.0	314.0	63.2	2.488	80.0	4.0	
SMR 0903	390.0	15.35	366.0	320.0	63.2	2.488	118.0	4.0	

Materialien/Materials

Zellulose, Kunststoffe
Cellulose, plastics

Optionen/Options

luftgetrocknet, hartverpresst, Farbe
air dried, pressed, color

N = Nawi-Kegel / Nawi cone
K = Konvex-Kegel / Convex cone

B

Standard Membranen, oval Oval cones

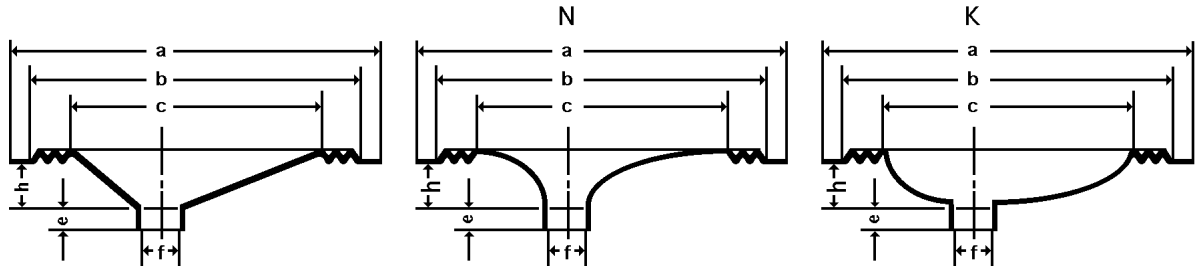

TYPE	Aussendurchmesser Outside diameter	Rillen- ausenmass Outer diameter of groove	Kegeldurch- messer Cone diameter	Halsdurchmesser Neck diameter	Höhe ohne Hals Height w/o neck	Hals- höhe Neck height	Form Form
	a	b	c	f	h	e	
	mm inches	mm	mm	mm inches	mm	mm	

Hals/Neck $\varnothing < 10$ mm

SMO 0949	130.0 x 65.0	5.12 x 2.56	116.0 x 58.0	104.0 x 46.0	4.0	0.157	15.0	
----------	--------------	-------------	--------------	--------------	-----	-------	------	--

12 mm \leq Hals/Neck $\varnothing < 14$ mm

SMO 0959	127.0 x 72.0	5.00 x 2.83	119.0 x 64.0	105.0 x 50.0	12.3	0.482	15.7	1.4
SMO 0917	130.0 x 77.0	5.12 x 3.03	122.0 x 69.0	107.0 x 54.0	12.3	0.482	16.0	2.0
SMO 0982	150.5 x 91.5	5.93 x 3.60	138.0 x 82.0	117.2 x 67.2	12.3	0.482	13.0	0.5
SMO 0675	139.0 x 91.5	5.47 x 3.60	130.0 x 82.5	116.4 x 70.1	12.4	0.488	14.0	1.5
SMO 0683	139.0 x 91.5	5.47 x 3.60	130.0 x 82.5	116.4 x 70.1	12.4	0.488	14.0	1.5
SMO 0945	127.0 x 72.0	5.00 x 2.83	118.0 x 63.0	106.0 x 51.0	12.5	0.490	15.7	1.4
SMO 0815	89.0 x 55.0	3.50 x 2.17	82.0 x 48.0	76.0 x 42.0	12.5	0.492	8.2	1.3
SMO 0586	99.0 x 33.0	3.90 x 1.30	92.3 x 27.3	84.4 x 19.4	12.5	0.492	5.8	3.0
SMO 0479	125.0 x 71.0	4.92 x 2.80	115.0 x 61.0	94.2 x 45.8	12.5	0.492	15.3	2.0
SMO 0689	125.0 x 71.0	4.92 x 2.80	115.0 x 61.0	95.1 x 47.1	12.5	0.492	15.3	2.0
SMO 0771	125.0 x 71.0	4.92 x 2.80	115.0 x 61.0	93.6 x 45.6	12.5	0.492	15.3	2.0
SMO 0671	139.0 x 91.5	5.47 x 3.60	130.0 x 82.5	116.4 x 70.1	12.5	0.492	16.9	2.0
SMO 0672	140.0 x 92.5	5.51 x 3.64	131.0 x 82.5	116.4 x 70.1	12.5	0.492	18.9	1.2
SMO 0592	124.0 x 70.0	4.88 x 2.76	117.0 x 63.0	101.7 x 47.7	12.7	0.500	12.0	2.5
SMO 0644	126.5 x 72.0	4.98 x 2.83	116.5 x 62.0	110.5 x 46.0	12.7	0.500	12.0	2.0
SMO 0577	100.0 x 65.0	3.94 x 2.56	92.0 x 57.0	85.2 x 50.2	12.8	0.504	12.3	1.5
SMO 0565	123.0 x 70.0	4.84 x 2.76	115.0 x 62.0	108.2 x 55.2	12.8	0.504	15.7	1.5

14 mm \leq Hals/Neck $\varnothing < 16$ mm

SMO 0650	126.0 x 72.0	4.96 x 2.83	117.0 x 63.0	94.2 x 48.2	14.2	0.559	21.0	2.0
SMO 0908	113.0 x 68.0	4.45 x 2.68	107.0 x 62.0	91.7 x 46.7	14.5	0.571	13.5	1.2
SMO 0779	150.5 x 92.0	5.93 x 3.62	138.5 x 80.0	119.5 x 65.0	14.6	0.575	22.2	1.8
SMO 0800	146.0 x 91.0	5.75 x 3.58	136.0 x 80.0	116.8 x 65.6	14.7	0.579	21.1	0.8
SMO 0732	152.5 x 101.6	6.00 x 4.00	142.5 x 90.0	128.6 x 76.1	14.8	0.583	14.2	1.5
SMO 0907	161.0 x 77.0	6.34 x 3.03	151.0 x 67.0	133.4 x 54.2	14.8	0.583	17.5	1.4
SMO 0720	179.0 x 120.5	7.05 x 4.74	167.3 x 110.0	148.3 x 91.0	14.8	0.583	32.2	1.3
SMO 0777	123.0 x 73.0	4.84 x 2.87	116.6 x 66.6	101.3 x 51.3	14.9	0.587	14.3	0.5

Materialien/Materials

Zellulose, Kunststoffe
Cellulose, plastics

Optionen/Options

luftgetrocknet, hartverpresst, Farbe
air dried, pressed, color

N = Nawi-Kegel / Nawi cone
K = Konvex-Kegel / Convex cone

B

Standard Membranen, oval Oval cones

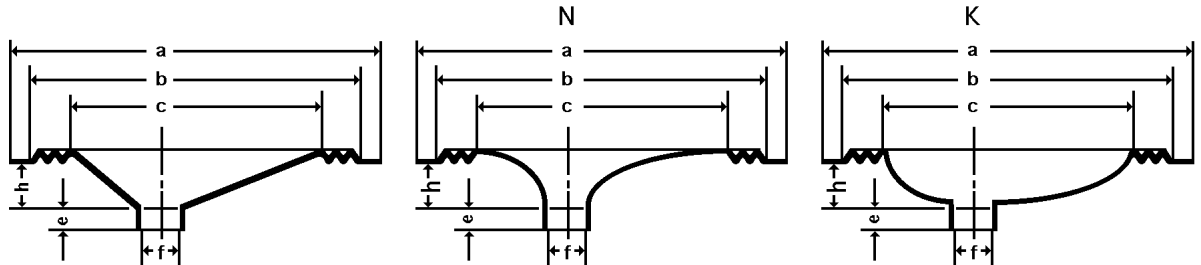

TYPE	Aussendurchmesser Outside diameter		Rillen- ausmass Outer diameter of groove	Kegeldurch- messer Cone diameter	Halsdurchmesser Neck diameter		Höhe ohne Hals Height w/o neck	Hals- höhe Neck height	Form Form
	a		b	c	f		h	e	
	mm	inches	mm	mm	mm	inches	mm	mm	

SMO 0712	125.0 x 71.0	4.92 x 2.80	117.0 x 63.0	103.0 x 49.0	14.9	0.587	14.0	1.0	
SMO 1071	146.0 x 96.0	5.75 x 3.78	139.0 x 89.0	123.0 x 73.0	14.9	0.587	17.5	1.5	
SMO 0690	149.2 x 98.4	5.87 x 3.87	141.2 x 90.4	124.2 x 73.4	14.9	0.587	15.0	0.5	
SMO 0717	151.5 x 100.0	5.96 x 3.94	143.0 x 91.0	124.8 x 73.3	14.9	0.587	17.0	2.0	
SMO 0818	87.0 x 57.0	3.43 x 2.24	82.0 x 52.0	72.0 x 42.0	15.0	0.591	10.0	1.0	
SMO 0804	122.0 x 67.0	4.80 x 2.64	114.0 x 59.0	104.1 x 49.1	15.0	0.591	13.0	1.0	
SMO 0808	125.0 x 70.0	4.92 x 2.76	116.0 x 64.0	106.1 x 54.1	15.0	0.591	15.0	1.0	
SMO 0853	152.0 x 102.0	5.98 x 4.02	144.0 x 94.0	128.0 x 78.0	15.0	0.591	17.5	1.0	
SMO 0866	120.5 x 66.5	4.74 x 2.62	112.5 x 58.5	98.5 x 48.5	15.1	0.594	11.5	1.0	
SMO 0702	175.0 x 99.0	6.89 x 3.90	165.0 x 88.0	155.0 x 78.0	15.1	0.594	24.0	1.0	
SMO 0662	126.5 x 72.0	4.98 x 2.83	118.0 x 63.0	108.3 x 53.3	15.2	0.598	21.0		
SMO 0703	151.0 x 99.0	5.94 x 3.90	140.0 x 88.0	126.0 x 74.0	15.4	0.606	17.0	1.2	
SMO 0823	201.0 x 78.0	7.91 x 3.07	189.0 x 66.0	170.6 x 47.6	15.5	0.610	20.0	0.5	
SMO 0831	248.0 x 64.0	9.76 x 2.52	236.0 x 58.0	217.0 x 47.0	15.5	0.610	25.0	0.8	

16 mm ≤ Hals/Neck ø < 18 mm

SMO 0869	123.5 x 73.0	4.86 x 2.87	116.6 x 65.6	102.8 x 51.8	16.2	0.638	14.6	1.2	
SMO 0872	152.5 x 101.5	6.00 x 4.00	140.5 x 89.5	124.1 x 73.1	16.2	0.638	16.7	1.5	
SMO 0888	174.6 x 100.8	6.87 x 3.97	163.8 x 89.9	147.0 x 73.1	16.2	0.638	21.0	1.5	
SMO 0904	126.5 x 72.0	4.98 x 2.83	118.2 x 63.2	108.3 x 53.3	16.4	0.646	23.6		
SMO 0557	126.5 x 72.0	4.98 x 2.83	114.5 x 60.0	108.5 x 54.0	16.5	0.650	21.0	2.0	
SMO 0730	139.0 x 91.5	5.47 x 3.60	128.0 x 80.0	115.4 x 68.3	16.5	0.650	18.0	1.5	
SMO 0649	148.0 x 92.0	5.83 x 3.62	135.0 x 79.0	115.2 x 64.6	16.5	0.650	21.0	3.0	
SMO 0637	149.0 x 98.0	5.87 x 3.86	140.0 x 89.0	121.6 x 75.0	16.5	0.650	19.8	2.0	
SMO 1000	150.5 x 91.5	5.93 x 3.60	138.0 x 82.0	117.2 x 67.2	16.5	0.650	16.0	0.5	
SMO 0759	166.0 x 111.0	6.54 x 4.37	156.3 x 101.3	139.4 x 84.4	16.5	0.650	25.5	2.5	
SMO 1015	167.9 x 112.5	6.61 x 4.43	159.9 x 104.5	138.8 x 88.7	16.5	0.650	26.0	1.5	
SMO 0796	168.0 x 92.0	6.61 x 3.62	158.4 x 82.4	144.5 x 70.5	16.5	0.650	26.6	1.5	
SMO 0988	168.0 x 112.5	6.61 x 4.43	160.0 x 104.5	138.8 x 88.7	16.5	0.650	26.0	1.5	
SMO 0715	171.0 x 121.0	6.73 x 4.76	156.0 x 106.0	140.0 x 90.0	16.5	0.650	18.5	2.0	
SMO 0947	206.0 x 91.0	8.11 x 3.58	196.0 x 81.0	174.8 x 64.6	16.5	0.650	25.0	1.5	
SMO 0868	123.0 x 72.2	4.84 x 2.84	119.1 x 68.3	106.9 x 56.1	16.6	0.654	11.6	1.5	
SMO 0538	126.5 x 72.0	4.98 x 2.83	114.5 x 60.0	107.5 x 53.0	16.6	0.654	21.0	2.0	

Materialien/Materials

Zellulose, Kunststoffe
Cellulose, plastics

Optionen/Options

luftgetrocknet, hartverpresst, Farbe
air dried, pressed, color

N = Nawi-Kegel / Nawi cone
K = Konvex-Kegel / Convex cone

B

Standard Membranen, oval Oval cones

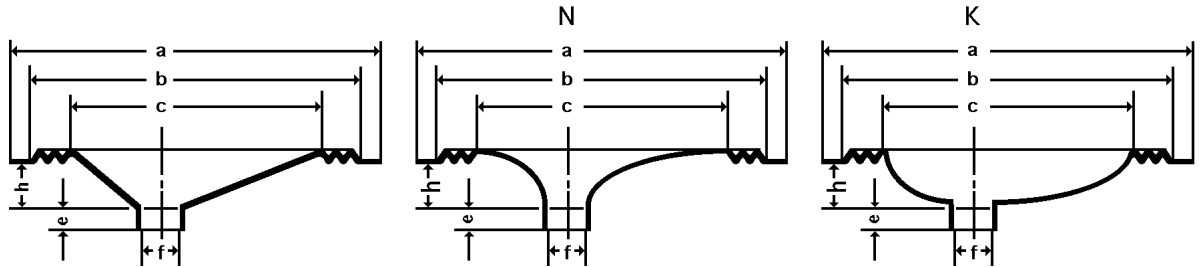

TYPE	Aussendurchmesser		Rillen-	Kegeldurch-	Halsdurchmesser		Höhe	Hals-	Form
	Outside diameter		aussenmass	messer	Neck diameter		ohne Hals	höhe	
			Outer diameter of groove	Cone diameter			Height w/o neck	Neck height	
	a		b	c	f		h	e	Form
	mm	inches	mm	mm	mm	inches	mm	mm	

SMO 0974	126.5 x 72.0	4.98 x 2.83	114.5 x 60.0	107.5 x 53.0	16.6	0.654	21.0	2.0	
SMO 0571	126.5 x 72.0	4.98 x 2.83	115.0 x 62.0	108.2 x 55.2	16.6	0.654	14.4	2.0	
SMO 0736	148.0 x 92.0	5.83 x 3.62	136.0 x 80.0	118.0 x 62.0	16.6	0.654	21.4	1.0	
SMO 0472	152.0 x 104.0	5.98 x 4.09	140.0 x 92.0	119.2 x 71.2	16.6	0.654	14.0	2.5	
SMO 0477	152.0 x 104.0	5.98 x 4.09	140.0 x 92.0	118.0 x 70.4	16.6	0.654	19.0	2.5	
SMO 0656	152.0 x 104.0	5.98 x 4.09	140.5 x 92.0	119.2 x 71.2	16.6	0.654	14.0	2.5	
SMO 0478	171.0 x 121.0	6.73 x 4.76	155.0 x 104.6	139.0 x 90.0	16.6	0.654	30.9	2.5	
SMO 0494	171.0 x 121.0	6.73 x 4.76	156.0 x 106.0	133.2 x 83.2	16.6	0.654	28.0	2.0	
SMO 0542	171.0 x 121.0	6.73 x 4.76	156.0 x 106.0	131.0 x 81.0	16.6	0.654	28.0	2.0	
SMO 0499	171.0 x 121.0	6.73 x 4.76	157.0 x 107.0	146.5 x 96.5	16.6	0.654	30.9	1.2	
SMO 0978	175.0 x 100.0	6.89 x 3.94	162.0 x 89.0	144.0 x 74.2	16.6	0.654	24.3	1.6	
SMO 0584	175.0 x 125.0	6.89 x 4.92	161.0 x 111.0	133.8 x 87.8	16.6	0.654	25.0	2.0	
SMO 0642	175.0 x 125.0	6.89 x 4.92	165.0 x 114.0	141.8 x 98.0	16.6	0.654	25.0	3.0	
SMO 0706	126.5 x 72.0	4.98 x 2.83	118.0 x 63.0	105.8 x 50.8	16.7	0.657	15.0	2.0	
SMO 0861	148.0 x 92.0	5.83 x 3.62	136.0 x 80.0	118.0 x 62.0	16.7	0.657	21.7	1.0	
SMO 0563	151.5 x 101.5	5.96 x 4.00	143.0 x 93.0	122.2 x 72.2	16.8	0.661	15.0	2.0	
SMO 0668	151.5 x 101.5	5.96 x 4.00	143.0 x 93.0	126.1 x 76.1	16.8	0.661	15.0	2.0	
SMO 0617	171.0 x 101.0	6.73 x 3.98	162.0 x 94.0	138.3 x 74.3	16.8	0.661	25.0	2.5	
SMO 0807	177.0 x 72.0	6.97 x 2.83	169.0 x 64.0	149.8 x 49.6	16.8	0.661	16.0	1.0	
SMO 0812	150.0 x 90.0	5.91 x 3.54	145.0 x 85.0	122.6 x 62.6	17.6	0.693	15.0	1.0	

18 mm ≤ Hals/Neck ø < 20 mm

SMO 0899	179.0 x 125.0	7.05 x 4.92	165.0 x 111.0	150.0 x 96.0	18.2	0.717	27.0	1.0	
SMO 0890	204.0 x 89.0	8.03 x 3.50	196.0 x 81.0	172.0 x 64.5	18.2	0.717	25.9	1.5	
SMO 0728	226.0 x 100.0	8.90 x 3.94	212.0 x 88.0	183.6 x 73.6	18.2	0.717	30.5	1.5	
SMO 0622	150.0 x 98.0	5.91 x 3.86	140.2 x 88.2	120.0 x 68.0	18.8	0.740	18.5	1.0	
SMO 0734	208.0 x 148.0	8.19 x 5.83	185.0 x 135.0	162.0	19.1	0.752	39.4	2.2	
SMO 0983	168.0 x 112.5	6.61 x 4.43	160.0 x 104.5	138.8 x 88.7	19.5	0.768	26.0	1.5	
SMO 0986	168.0 x 112.5	6.61 x 4.43	160.0 x 104.5	138.8 x 88.7	19.5	0.768	23.5	1.5	
SMO 0931	184.0 x 122.0	7.24 x 4.80	172.0 x 111.0	149.0 x 88.0	19.5	0.768	24.5	1.5	
SMO 0874	204.0 x 89.0	8.03 x 3.50	196.0 x 81.0	172.0 x 64.5	19.5	0.768	25.0	1.5	
SMO 0465	242.0 x 162.0	9.53 x 6.38	230.0 x 150.0	200.4 x 120.4	19.5	0.768	48.0	2.0	
SMO 0638	148.0 x 92.0	5.83 x 3.62	135.0 x 79.0	115.2 x 64.6	19.6	0.772	21.0	3.0	

Materialien/Materials

Zellulose, Kunststoffe
Cellulose, plastics

Optionen/Options

luftgetrocknet, hartverpresst, Farbe
air dried, pressed, color

N = Nawi-Kegel / Nawi cone
K = Konvex-Kegel / Convex cone

B

Standard Membranen, oval Oval cones

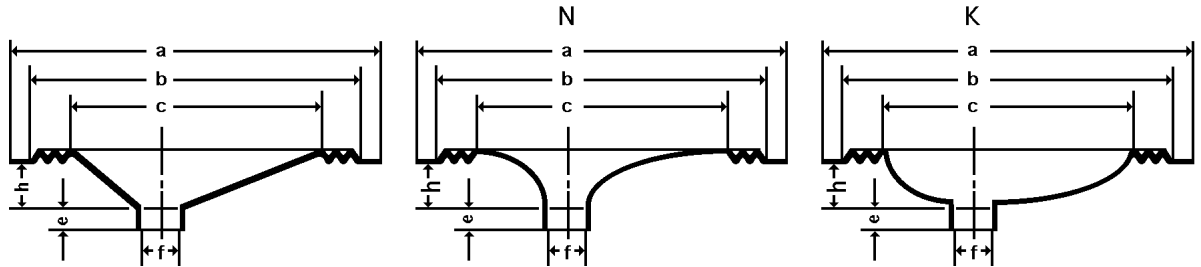

TYPE	Aussendurchmesser		Rillen-	Kegeldurch-	Halsdurchmesser		Höhe	Hals-	Form
	Outside diameter		aussenmass	durchmesser	Neck diameter		ohne Hals	höhe	
	a		Outer diameter of groove	Cone diameter	f		Height w/o neck	Neck height	
	mm	inches	b	c	mm	inches	h	e	Form
			mm	mm			mm	mm	
SMO 0897	148.0 x 92.0	5.83 x 3.62	138.0 x 82.0	122.0 x 68.0	19.6	0.772	21.0	1.5	
SMO 0934	149.0 x 98.0	5.87 x 3.86	140.0 x 89.0	120.4 x 69.4	19.6	0.772	19.0	2.0	
SMO 0624	152.0 x 99.0	5.98 x 3.90	139.0 x 88.0	126.0 x 75.0	19.6	0.772	17.0	1.3	
SMO 0594	153.0 x 103.0	6.02 x 4.06	143.0 x 93.0	125.0 x 75.0	19.6	0.772	15.0	0.8	
SMO 0860	168.0 x 92.0	6.61 x 3.62	158.4 x 82.4	144.5 x 70.5	19.6	0.772	21.2	1.5	
SMO 0926	171.0 x 121.0	6.73 x 4.76	156.0 x 106.0	138.4 x 88.4	19.6	0.772	18.5	2.0	
SMO 1020	171.0 x 121.0	6.73 x 4.76	156.0 x 106.0	140.0 x 90.0	19.6	0.772	29.0	1.5	
SMO 0568	175.0 x 100.0	6.89 x 3.94	160.0 x 90.0	138.3 x 74.3	19.6	0.772	25.0	2.5	
SMO 1010	204.0 x 90.0	8.03 x 3.54	187.0 x 81.0	162.8 x 61.6	19.6	0.772	25.0	1.5	
SMO 0964	206.0 x 91.0	8.11 x 3.58	196.0 x 81.0	174.8 x 64.6	19.6	0.772	25.0	1.5	
SMO 0980	206.0 x 91.0	8.11 x 3.58	196.0 x 81.0	174.8 x 64.6	19.6	0.772	23.6		
SMO 0619	208.0 x 148.0	8.19 x 5.83	194.0 x 134.0	159.2 x 107.2	19.6	0.772	39.5	2.0	
SMO 0537	230.0 x 158.0	9.06 x 6.22	218.0 x 146.0	188.0 x 116.0	19.6	0.772	42.0	1.0	
SMO 0659	235.0 x 148.0	9.25 x 5.83	221.0 x 134.0	196.0 x 112.0	19.6	0.772	32.0	2.0	
SMO 0455	242.0 x 162.0	9.53 x 6.38	232.0 x 152.0	208.0 x 128.0	19.6	0.772	48.0	2.0	
SMO 0456	245.0 x 165.0	9.65 x 6.50	232.0 x 152.0	207.0 x 127.0	19.6	0.772	48.0	2.0	
SMO 0596	281.0 x 171.0	11.06 x 6.73	265.0 x 155.0	232.1 x 132.1	19.6	0.772	55.0	3.0	
SMO 0687	149.0 x 98.0	5.87 x 3.86	140.0 x 89.0	120.4 x 69.4	19.7	0.776	19.0	2.0	
SMO 0787	152.0 x 100.0	5.98 x 3.94	139.0 x 87.0	126.0 x 74.0	19.7	0.776	17.0	1.0	
SMO 0648	152.0 x 102.0	5.98 x 4.02	141.0 x 91.0	122.0 x 77.0	19.7	0.776	17.0	2.2	
SMO 0554	158.0 x 94.0	6.22 x 3.70	146.0 x 82.0	125.0 x 61.0	19.7	0.776	22.0	1.5	
SMO 0639	171.0 x 125.0	6.73 x 4.92	158.0 x 111.0	130.8 x 87.8	19.7	0.776	25.0	2.0	
SMO 0803	172.0 x 104.0	6.77 x 4.09	162.0 x 94.0	138.3 x 74.3	19.7	0.776	24.3	1.5	
SMO 0966	184.0 x 122.0	7.24 x 4.80	174.0 x 114.0	155.0 x 95.0	19.7	0.776	24.5	1.5	
SMO 0802	226.0 x 108.0	8.90 x 4.25	214.0 x 96.0	200.0 x 82.0	19.7	0.776	31.2	2.0	
SMO 0598	235.0 x 148.0	9.25 x 5.83	224.0 x 134.0	193.4 x 111.4	19.7	0.776	40.0	2.0	
SMO 0695	243.4 x 124.2	9.58 x 4.89	226.4 x 107.2	204.8 x 88.8	19.7	0.776	43.1	2.5	
SMO 0611	255.0 x 125.0	10.04 x 4.92	238.0 x 112.0	208.0 x 92.0	19.7	0.776	42.5	2.0	
SMO 0633	255.0 x 145.0	10.04 x 5.71	237.0 x 127.0	206.2 x 104.6	19.7	0.776	43.8	2.5	
SMO 0670	255.0 x 147.0	10.04 x 5.79	237.0 x 129.0	206.2 x 106.6	19.7	0.776	45.3	2.5	
SMO 0464	255.0 x 175.0	10.04 x 6.89	235.0 x 155.0	202.2 x 132.2	19.7	0.776	50.0	2.0	
SMO 0473	255.0 x 175.0	10.04 x 6.89	235.0 x 155.0	199.0 x 129.0	19.7	0.776	50.0	4.0	
SMO 0482	255.0 x 175.0	10.04 x 6.89	235.0 x 155.0	201.0 x 130.0	19.7	0.776	50.0	3.0	
SMO 0498	148.0 x 92.0	5.83 x 3.62	136.0 x 80.0	118.0 x 62.0	19.8	0.780	21.0	3.0	

Materialien/Materials

Zellulose, Kunststoff
Cellulose, plastics

Optionen/Options

luftgetrocknet, hartverpresst, Farbe
air dried, pressed, color

N = Nawi-Kegel / Nawi cone
K = Konvex-Kegel / Convex cone

B

Standard Membranen, oval Oval cones

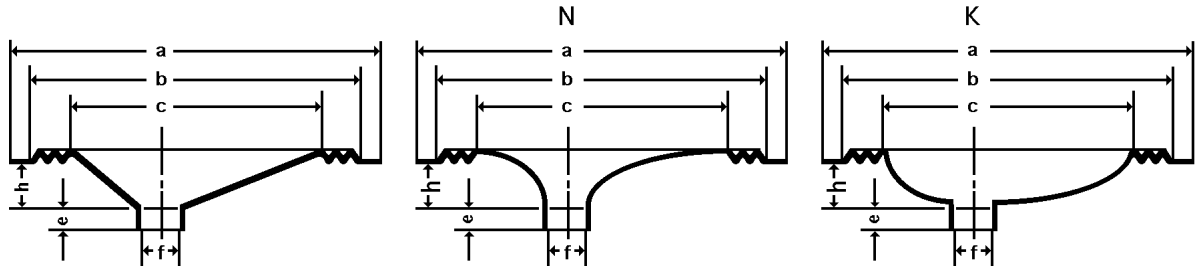

TYPE	Aussendurchmesser		Rillen-	Kegeldurch-	Halsdurchmesser		Höhe	Hals-	Form
	Outside diameter		aussenmass	messer	Neck diameter		ohne Hals	höhe	Form
	a		Outer diameter	Cone	f		Height	Neck	Form
	mm	inches	b	diameter	mm	inches	h	height	e
			mm	c	mm		mm	mm	
SMO 0940	148.0 x 92.0	5.83 x 3.62	138.0 x 82.0	124.6 x 70.6	19.8	0.780	21.0	2.5	
SMO 0641	171.0 x 121.0	6.73 x 4.76	155.0 x 105.0	139.0 x 89.0	19.8	0.780	29.0	2.5	
SMO 0481	171.0 x 121.0	6.73 x 4.76	156.0 x 106.0	133.2 x 90.0	19.8	0.780	29.0	2.0	
SMO 0545	171.0 x 121.0	6.73 x 4.76	156.0 x 106.0	131.0 x 81.0	19.8	0.780	27.0	2.5	
SMO 0630	175.0 x 125.0	6.89 x 4.92	159.8 x 110.8	134.1 x 89.5	19.8	0.780	30.0	1.0	
SMO 0476	204.0 x 144.0	8.03 x 5.67	188.0 x 128.0	153.4 x 103.4	19.8	0.780	37.0	3.0	
SMO 0589	208.0 x 148.0	8.19 x 5.83	182.4 x 134.4	160.0 x 112.0	19.8	0.780	39.5	2.0	
SMO 0674	208.0 x 148.0	8.19 x 5.83	184.0 x 134.0	162.0 x 117.6	19.8	0.780	36.0	2.0	
SMO 0817	208.0 x 148.0	8.19 x 5.83	184.0 x 134.0	162.0 x 117.6	19.8	0.780	36.0	2.0	
SMO 0629	208.0 x 148.0	8.19 x 5.83	192.4 x 132.4	159.0 x 107.0	19.8	0.780	35.0	1.0	
SMO 0694	208.0 x 148.0	8.19 x 5.83	193.0 x 133.0	176.4 x 116.4	19.8	0.780	35.0	2.0	
SMO 0635	212.0 x 111.5	8.35 x 4.39	198.0 x 97.5	170.0 x 79.5	19.8	0.780	36.8	2.0	
SMO 0609	235.0 x 148.0	9.25 x 5.83	221.0 x 134.0	196.0 x 112.0	19.8	0.780	43.0	2.0	
SMO 0684	247.0 x 70.0	9.72 x 2.76	238.0 x 61.0	215.2 x 44.6	19.8	0.780	20.5	3.0	
SMO 0704	247.0 x 70.0	9.72 x 2.76	238.0 x 61.0	221.4 x 44.4	19.8	0.780	20.5	4.0	
SMO 0518	248.0 x 168.0	9.76 x 6.61	230.0 x 150.0	196.4 x 125.6	19.8	0.780	30.0	2.5	
SMO 0529	248.0 x 168.0	9.76 x 6.61	230.0 x 150.0	206.7 x 130.7	19.8	0.780	30.0	2.5	
SMO 0503	255.0 x 175.0	10.04 x 6.89	235.0 x 155.0	202.2 x 132.2	19.8	0.780	50.3	4.7	
SMO 0733	152.5 x 101.6	6.00 x 4.00	142.5 x 90.0	128.6 x 76.1	19.9	0.781	14.2	1.5	
20 mm ≤ Hals/Neck ø < 25 mm									
SMO 0463	198.0 x 137.0	7.80 x 5.39	188.0 x 127.0	154.9 x 103.5	20.2	0.795	50.0	2.5	
SMO 0708	175.0 x 125.0	6.89 x 4.92	158.0 x 111.0	135.6 x 92.6	21.2	0.835	24.0	1.2	
SMO 0681	186.0 x 95.0	7.32 x 3.74	177.0 x 88.0	156.4 x 16.8	23.0	0.906	1.0		
25 mm ≤ Hals/Neck ø < 30 mm									
SMO 0339	255.0 x 175.0	10.04 x 6.89	235.0 x 155.0	201.0 x 130.0	25.7	1.012	50.0	3.0	
SMO 0462	304.0 x 194.0	11.97 x 7.64	284.0 x 174.0	240.0 x 138.6	25.8	1.016	77.0	3.0	
SMO 0539	310.0 x 200.0	12.20 x 7.87	284.0 x 174.0	239.6 x 129.6	25.8	1.016	77.0	3.0	
30 mm ≤ Hals/Neck ø < 35 mm									
SMO 0458	350.0 x 210.0	13.78 x 8.27	330.0 x 187.0	298.0 x 158.0	30.8	1.213	44.0	6.0	
SMO 0460	250.0 x 210.0	9.84 x 8.27	330.0 x 190.0	290.4 x 158.4	30.9	1.217	54.5	2.5	

Materialien/Materials

Zellulose, Kunststoffe
Cellulose, plastics

Optionen/Options

luftgetrocknet, hartverpresst, Farbe
air dried, pressed, color

N = Nawi-Kegel / Nawi cone
K = Konvex-Kegel / Convex cone

B

Standard Membranen, oval Oval cones

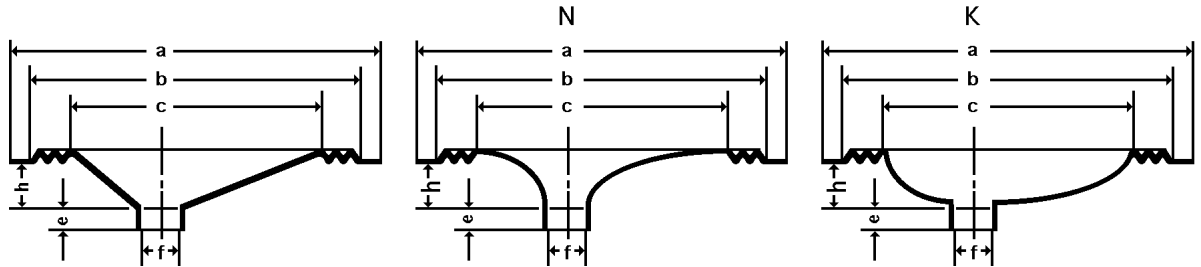

TYPE	Aussendurchmesser	Rillen- ausenmass	Kegeldurch- messer	Halsdurchmesser		Höhe ohne Hals	Hals- höhe	Form
	Outside diameter	Outer diameter of groove	Cone diameter	Neck diameter		Height w/o neck	Neck height	Form
	a	b	c	f		h	e	
	mm inches	mm	mm	mm inches		mm	mm	

SMO 0474	342.0 x 209.0 13.46 x 8.23	326.0 x 190.0	286.8 x 154.0	31.7	1.248	67.0	3.0	
SMO 0459	342.0 x 209.0 13.46 x 8.23	326.0 x 190.0	290.8 x 158.0	32.5	1.280	67.0	3.0	

Materialien/Materials

Zellulose, Kunststoffe
Cellulose, plastics

Optionen/Options

luftgetrocknet, hartverpresst, Farbe
air dried, pressed, color

N = Nawi-Kegel / Nawi cone
K = Konvex-Kegel / Convex cone

C

Sickenringe, rund Round roll surrounds

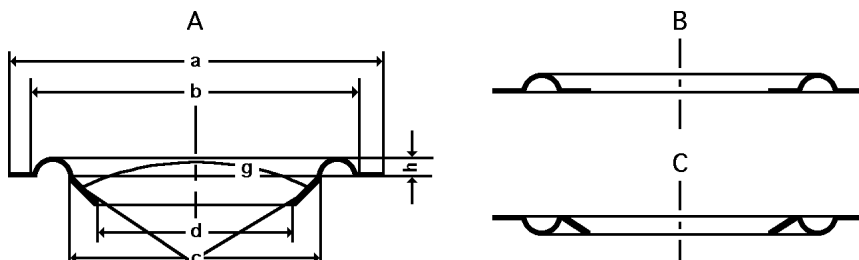

TYPE	Aussendurchmesser		Einspanndurchmesser	Basisdurchmesser	Innendurchmesser	Sickenhöhe	Form	Klebwinkel
	Outside diameter							
	a		b	c	d	h		
	mm	inches	mm	mm	mm	mm		Grad/Degrees

SR 1121	45.5	1.79	44.7	34.2	30.6	2.8	A	110.0
SR 1165	54.5	2.15	50.0	38.6	35.5	3.3	A	136.0
SR 1132	62.5	2.46	57.8	46.0	41.0	2.8	A	128.0
SR 0943	83.0	3.27	75.5	63.2	56.0	2.2	A	133.0
SR 1158	83.3	3.28	79.0	67.2	62.5	4.5	A	128.0
SR 1049	83.4	3.28	79.4	67.5	63.8	4.0	A	133.0
SR 1056	83.4	3.28	79.6	66.8	63.8	4.8	A	131.0
SR 1108	83.4	3.28	79.6	70.0	66.8	3.5	A	138.0
SR 1104	83.5	3.29	72.4	58.0	52.0	3.1	A	113.0
SR 1036	83.5	3.29	75.5	63.2	56.0	2.2	A	133.0
SR 1137	95.5	3.76	88.0	72.8	66.6	3.5	C	140.0
SR 1170	96.0	3.78	89.6	79.2	74.6	4.4	A	142.0
SR 1130	96.0	3.78	89.8	71.2	65.2	5.0	A	134.0
SR 0992	96.0	3.78	91.0	76.2	72.2	4.9	A	126.0
SR 1033	96.0	3.78	91.4	76.4	71.6	5.8	A	136.0
SR 1083	96.0	3.78	91.4	76.4	71.6	4.8	A	136.0
SR 1024	96.0	3.78	91.5	76.3	72.2	4.9	A	126.0
SR 1139	96.6	3.80		75.8	66.0	2.6	A	138.0
SR 1162	96.6	3.80			68.5	4.5	A	138.0
SR 1116	96.6	3.80		76.0	71.0	4.5	A	108.0
SR 1063	97.0	3.82	78.5	70.0	65.4	2.0	A	114.0
SR 1155	97.0	3.82	90.9	76.0	66.0	2.6	A	138.0
SR 0999	102.0	4.02	96.6	81.2	77.0	5.1	A	123.0
SR 1057	102.0	4.02	97.2	81.2	77.0	5.1	A	118.0
SR 1150	109.0	4.29		85.8	79.2	6.3	A	120.0
SR 1163	109.0	4.29	101.9	85.0	77.8	5.0	A	
SR 1157	109.0	4.29	102.6	85.7	79.2	5.0	A	132.0
SR 1156	116.0	4.57	107.9	91.7	85.0	4.7	A	132.0
SR 1138	116.5	4.59		97.0	88.0	2.7	A	132.0
SR 1129	119.0	4.69	110.0	92.0	84.5	5.0	A	130.0
SR 0843	122.0	4.80	110.0	92.0	84.5	5.0	A	130.0

Materialien/Materials
Gummi, Schaumstoff, Gewebe
Rubber, foam, fabric

Optionen/Options
Farbe
Color

C

Sickenringe, rund Round roll surrounds

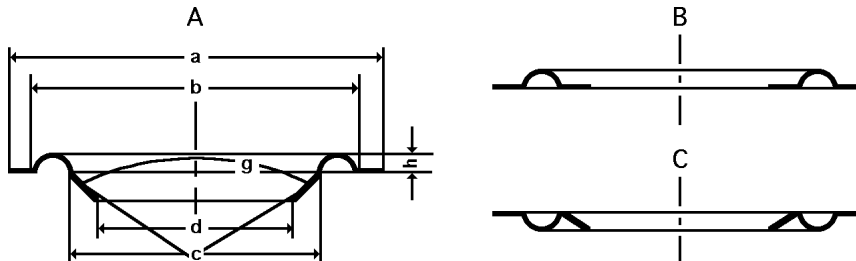

TYPE	Aussendurchmesser		Einspanndurchmesser	Basisdurchmesser	Innendurchmesser	Sickenhöhe	Form	Klebewinkel
	Outside diameter							
	a		b	c	d	h		
	mm	inches	mm	mm	mm	mm		Grad/Degrees
SR 0843	122.0	4.80	110.0	92.0	84.5	5.0	A	130.0
SR 1167	122.5	4.82	116.6	96.9	90.0	5.3	A	132.0
SR 0996	123.0	4.84	113.5	97.2	91.2	5.5	A	117.0
SR 1127	124.0	4.88		92.8	84.5	5.0	A	136.0
SR 1143	124.0	4.88		92.2	84.5	3.9	A	136.0
SR 1127	124.0	4.88		92.8	84.5	5.0	A	136.0
SR 1119	124.0	4.88	116.7	106.5	102.5	3.4	A	150.0
SR 0913	126.0	4.96	110.0	92.0	85.5	5.0	A	114.0
SR 1092	126.0	4.96	112.0	97.2	91.5	4.2	C	113.0
SR 0930	126.0	4.96	112.5	89.7	83.0	4.7	B	
SR 1082	126.0	4.96	113.7	97.5	90.0	4.8	C	113.0
SR 0995	126.0	4.96	114.0	91.0	85.0	5.4	A	112.0
SR 1002	126.0	4.96	115.6	91.5	84.0	8.0	A	120.0
SR 1087	126.0	4.96	118.1	96.6	91.0	4.5	A	114.0
SR 0922	131.0	5.16	116.0	99.7	90.0	5.0	A	137.0
SR 1144	132.0	5.20		106.4	98.8	4.8	A	132.0
SR 0928	140.0	5.51	131.0	104.0	97.0	5.6	A	152.0
SR 1016	140.0	5.51	131.0	104.0	97.0	5.6	A	152.0
SR 1151	150.0	5.91	140.5	125.3	113.0	4.7	C	144.0
SR 1005	152.0	5.98	142.0	122.6	114.0	4.7	A	138.0
SR 1005	152.0	5.98	142.0	122.6	114.0	4.7	A	138.0
SR 1120	156.0	6.14		124.1	114.5	6.9	A	138.0
SR 0878	164.0	6.46	146.0	121.0	116.5	8.4	A	90.0
SR 1030	170.5	6.71	160.0	139.0	133.2	7.9	A	120.0
SR 1003	170.5	6.71	161.4	132.0	123.0	9.5	A	112.0
SR 0952	171.0	6.73	161.0	130.0	122.0	6.5	B	
SR 0985	172.0	6.77	161.0	125.4	115.0	8.7	A	121.0
SR 0936	172.0	6.77	161.0	132.0	123.0	8.2	A	139.0
SR 0880	172.0	6.77	161.0	132.0	126.8	8.2	B	
SR 1070	177.0	6.97	160.6	139.3	133.2	7.9	A	120.0
SR 0956	196.0	7.72	183.0	153.5	146.5	6.8	A	140.0
SR 0970	196.0	7.72	183.0	153.5	146.5	6.8	A	121.0
SR 1068	196.0	7.72	185.0	152.8	146.8	7.5	C	124.0
SR 1059	196.0	7.72	185.1	162.1	156.0	7.5	A	120.0

Materialien/Materials
Gummi, Schaumstoff, Gewebe
Rubber, foam, fabric

Optionen/Options
Farbe
Color

C

Sickenringe, rund Round roll surrounds

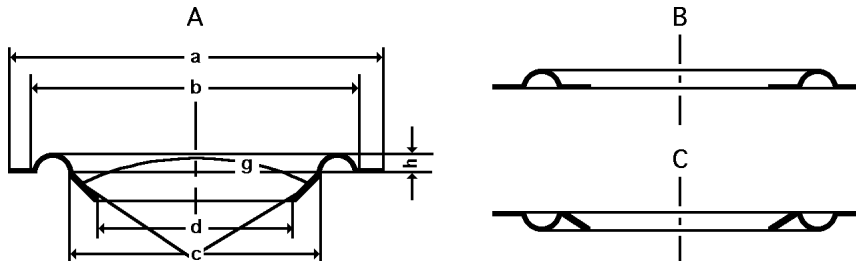

TYPE	Aussendurchmesser		Einspanndurchmesser	Basisdurchmesser	Innendurchmesser	Sickenhöhe	Form	Klebwinkel
	Outside diameter							
	a		b	c	d	h		
	mm	inches	mm	mm	mm	mm		Grad/Degrees
SR 0954	198.0	7.80	183.0	152.0	145.0	6.5	B	124.0
SR 0994	198.0	7.80	184.0	151.2	143.0	10.0	A	110.0
SR 0998	198.0	7.80	184.0	151.4	143.0	10.0	A	110.0
SR 0939	200.0	7.87	186.0	151.0	140.0	8.3	A	131.0
SR 0873	200.0	7.87	186.0	150.0	144.5	9.6	B	
SR 0859	202.0	7.95	185.0	152.4	142.0	8.0	A	131.0
SR 0876	207.0	8.15	186.0	149.7	143.9	11.0	A	90.0
SR 1047	214.0	8.43	183.0	152.0	146.8	7.5	A	120.0
SR 1009	236.0	9.29	217.0	188.0	182.0	9.1	A	120.0
SR 0849	238.0	9.37	220.0	186.0	175.0	7.6	C	137.0
SR 1014	239.0	9.41	222.0	185.0	175.0	8.0	A	114.0
SR 1084	239.0	9.41	222.0	185.0	175.0	8.0	A	154.0
SR 1014	239.0	9.41	222.0	185.0	175.0	8.0	A	114.0
SR 1117	239.0	9.41	225.6	200.6	185.0	7.2	A	117.0
SR 0769	240.0	9.45	222.0	185.0	175.0	7.3	A	122.0
SR 0879	245.0	9.65	226.0	189.0	181.0	12.0	A	109.0
SR 1098	273.0	10.75	257.8	224.8	212.0	8.0	A	120.0
SR 1006	295.0	11.61	276.0	240.8	230.0	9.0	A	113.0

Materialien/Materials
Gummi, Schaumstoff, Gewebe
Rubber, foam, fabric

Optionen/Options
Farbe
Color

D

Sickenringe, oval Oval roll surrounds

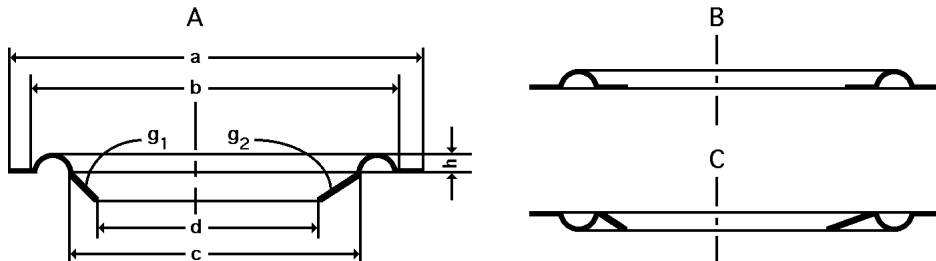

TYPE	Aussendurchmesser Outside diameter a mm inches	Einspann- durchmesser Clamping diameter b mm	Basisdurch- messer Base diameter c mm	Innen- durchmesser Inside- diameter d mm	Sickenhöhe Height of surround h mm	Form Form	Klebe- winkel Glueing angle Grad/Degrees
------	---	--	---	--	---	--------------	--

Hals/Neck $\varnothing \geq 50\text{mm}$

SO 1112	125.0 x 71.0	4.92 x 2.80	116.6 x 64.6	105.0 x 53.0	98.2 x 46.20	2.9	A	120 / 120
SO 1095	155.0 x 75.0	6.10 x 2.95	145.5 x 68.5	129.2 x 52.2	123.2 x 48.50	4.0	A	146 / 180
SO 1125	150.0 x 90.5	5.91 x 3.56	142.0 x 82.0	131.0 x 71.0	124.0 x 64.00	3.8	C	140 / 140
SO 1133	155.0 x 74.0	6.10 x 2.91	139.0 x 59.5	132.0 x 52.5	124.0 x 46.50	4.0	A	145 / 76
SO 0111	150.5 x 94.5	5.93 x 3.72	142.7 x 82.3	131.3 x 70.6	126.3 x 65.60	4.0	A	150 / 88
SO 1038	167.9 x 112.4	6.61 x 4.43	160.2 x 104.7	147.4 x 91.9	141.4 x 86.70	5.4	A	150 / 110

Materialien/Materials

Gummi, Schaumstoff, Gewebe
Rubber, foam, fabric

Optionen/Options

Farbe
Color

E

Membrankegel, rund Cone bodies, round

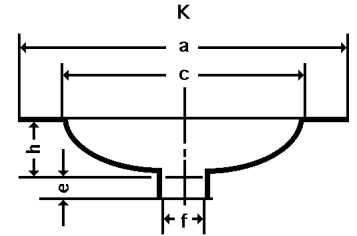
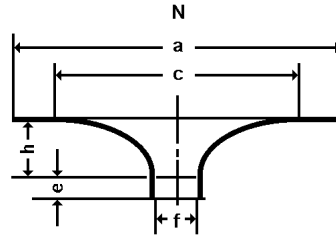
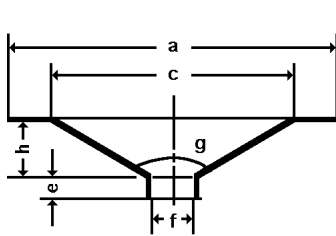

TYPE	Aussendurchmesser Outside diameter	Basisdurchmesser Base diameter	Halsdurchmesser Neck diameter	Höhe ohne Hals Height w/o neck	Hals- höhe Neck height	Klebe- winkel Glueing angle
	a	c	f	h	e	
	mm inches	mm inches	mm inches	mm	mm	Grad/Degrees

MKR 1218	121.0	4.76			21.3				
12 mm ≤ Hals/Neck ø < 14 mm									
MKR 0354	39.0	1.54			1.5				
16 mm ≤ Hals/Neck ø < 18 mm									
MKR 1058			67.6	2.66	16.5	0.650	13.9	1.5	
MKR 1105			67.6	2.66	16.5	0.650	14.0	1.5	120.0
MKR 1058			67.6	2.66	16.5	0.650	13.9	1.5	
MKR 1035			76.0	2.99	16.5	0.650	15.5	1.5	
MKR 1109			69.4	2.73	17.2	0.677	14.3	1.5	120.0
18 mm ≤ Hals/Neck ø < 20 mm									
MKR 1054			68.4	2.69	19.5	0.768	11.5	1.5	131.0
MKR 0992			76.0	2.99	19.5	0.768	15.0	1.5	
MKR 1018			77.0	3.03	19.5	0.768	15.2	1.5	124.0
MKR 0999			82.0	3.23	19.5	0.768	17.2	1.5	123.0
MKR 1004			97.0	3.82	19.5	0.768	22.7	2.0	
MKR 1007			97.0	3.82	19.5	0.768	22.4	2.0	120.0
MKR 1091			58.0	2.28	19.6	0.772	13.0	1.5	113.0
MKR 1115			58.0	2.28	19.6	0.772	13.0	1.5	132.0
MKR 1043			62.0	2.44	19.6	0.772	10.0	1.5	
MKR 0944			63.0	2.48	19.6	0.772	9.5	1.5	133.0
MKR 1052			67.6	2.66	19.6	0.772	10.8	1.5	131.0
MKR 1034			70.0	2.76	19.6	0.772	13.8	1.5	
MKR 1055			71.0	2.80	19.6	0.772	10.0	1.5	
MKR 1093			82.0	3.23	19.6	0.772	18.3	2.0	120.0
MKR 1045			93.5	3.68	19.6	0.772	11.5	1.5	
MKR 1021			122.0	4.80	19.6	0.772	23.8	2.0	
MKR 0843			90.5	3.56	19.7	0.776	24.0	1.5	

Materialien/Materials

Zellulose, Kunststoffe, Glasfaser
Cellulose, plastics, fiberglass

Optionen/Options

luftgetrocknet, hartverpresst, Farbe
air dried, pressed, color

N = Nawi-Kegel / Nawi cone
K = Konvex-Kegel / Convex cone

E

Membrankegel, rund Cone bodies, round

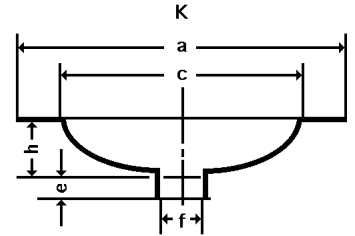
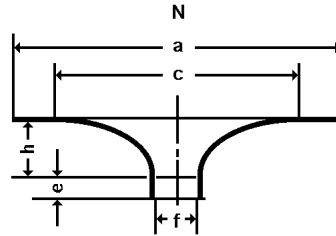
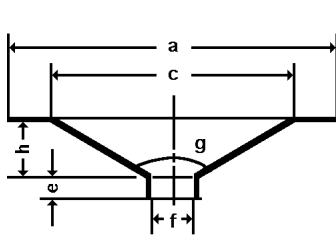

TYPE	Aussendurchmesser		Basisdurchmesser		Halsdurchmesser		Höhe ohne Hals	Hals-höhe	Klebe- winkel Glueing angle Grad/Degrees
	Outside diameter		Base diameter		Neck diameter		Height w/o neck	Neck height	
	a		c		f		h	e	
	mm	inches	mm	inches	mm	inches	mm	mm	

MKR 0987			92.0	3.62	19.7	0.776	24.0	1.5	
MKR 1168			98.0	3.86	19.7	0.776	24.0	1.5	120.0
MKR 1122			106.0	4.17	19.7	0.776	23.0	1.5	120.0
MKR 1107			121.0	4.76	19.7	0.776	25.2	2.0	200.0
MKR 1146			85.0	3.35	19.8	0.780	16.2	1.5	120.0
MKR 0922			98.0	3.86	19.8	0.780	28.5	1.5	
MKR 1025			124.0	4.88	19.8	0.780	34.0	2.0	

25 mm ≤ Hals/Neck ø < 30 mm

MKR 1044			82.0	3.23	25.4	1.000	17.2	1.5	117.0
MKR 1031			139.2	5.48	25.4	1.000	32.6	2.0	120.0
MKR 1088			76.0	2.99	25.5	1.004	17.0	2.0	
MKR 0984			90.5	3.56	25.5	1.004	20.7	2.0	113.0
MKR 0997			97.0	3.82	25.5	1.004	22.7	2.0	116.0
MKR 0965			125.0	4.92	25.5	1.004	31.6	2.5	
MKR 0985			126.5	4.98	25.5	1.004	29.3	2.0	120.0
MKR 0989			133.4	5.25	25.5	1.004	30.9	2.0	118.0
MKR 1094			133.4	5.25	25.5	1.004	31.0	2.0	121.0
MKR 1072			163.0	6.42	25.5	1.004	39.6	3.0	120.0
MKR 1009			190.0	7.48	25.5	1.004	47.2	3.0	120.0
MKR 0928			103.0	4.06	25.6	1.008	20.3	2.0	
MKR 0876			149.7	5.89	25.6	1.008	40.1	3.5	
MKR 0969			152.0	5.98	25.6	1.008	35.7	2.0	121.0
MKR 0879			189.0	7.44	25.6	1.008	58.5	2.5	109.0
MKR 1077			76.0	2.99	25.7	1.010	17.1	2.5	
MKR 1022			91.0	3.58	25.7	1.012	17.4	1.5	124.0
MKR 1074			95.0	3.74	25.7	1.012	24.3		
MKR 1128			123.0	4.84	25.7	1.012	24.8	1.5	215.0
MKR 1174			123.0	4.84	25.7	1.012	23.0	1.5	215.0
MKR 1079			124.0	4.88	25.7	1.012	30.5	2.0	116.0
MKR 0794			152.0	5.98	25.7	1.012	39.1	2.0	116.0
MKR 1106			153.5	6.04	25.7	1.012	39.5	2.0	109.0
MKR 1053			76.0	2.99	25.8	1.016	15.0	1.5	

Materialien/Materials

Zellulose, Kunststoffe, Glasfaser
Cellulose, plastics, fiberglass

Optionen/Options

luftgetrocknet, hartverpresst, Farbe
air dried, pressed, color

N = Nawi-Kegel / Nawi cone
K = Konvex-Kegel / Convex cone

E

Membrankegel, rund Cone bodies, round

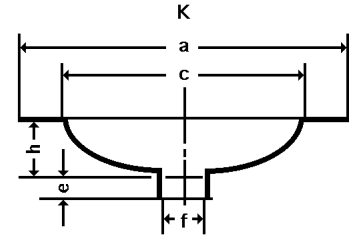
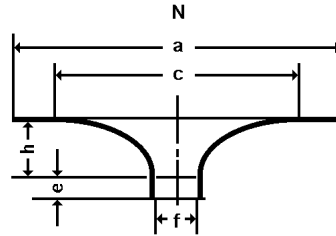
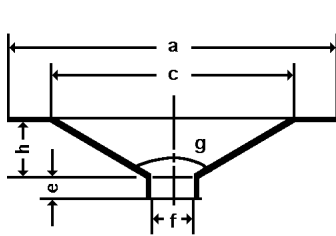

TYPE	Aussendurchmesser		Basisdurchmesser		Halsdurchmesser		Höhe ohne Hals	Hals-höhe	Klebe-winkel
	Outside diameter		Base diameter		Neck diameter		Height w/o neck	Neck height	
	a		c		f		h	e	
	mm	inches	mm	inches	mm	inches	mm	mm	Grad/Degrees
MKR 1148			85.0	3.35	25.8	1.016	15.2	1.5	215.0
MKR 1023			92.0	3.62	25.8	1.016	22.3	2.5	
MKR 1086			97.0	3.82	25.8	1.016	23.6	1.8	133.0
MKR 0878			121.0	4.76	25.8	1.016	51.3	2.0	86.0
MKR 1005			121.0	4.76	25.8	1.016	24.2	2.0	
MKR 1152			121.0	4.76	25.8	1.016	21.7	1.5	215.0
MKR 1027			124.0	4.88	25.8	1.016	31.0	2.0	
MKR 1008			132.0	5.20	25.8	1.016	32.3	2.5	
MKR 1066			135.0	5.31	25.8	1.016	33.0	2.5	
MKR 0882			151.2	5.95	25.8	1.016	42.0	2.0	112.0
MKR 1042			184.5	7.26	25.8	1.016	52.6	2.0	113.0
MKR 1142			184.5	7.26	25.8	1.016	52.6	2.0	113.0
MKR 0930	90.0	3.54		0.00	25.8	1.016	15.0	2.0	
MKR 0950	130.0	5.12		0.00	25.8	1.016	28.5	2.0	
MKR 0951	152.0	5.98		0.00	25.8	1.016	35.2	2.0	
MKR 0953	191.0	7.52		0.00	25.8	1.016	55.8	2.0	
MKR 0913			91.0	3.58	25.9	1.018	16.0	2.5	129.0
MKR 0962			91.0	3.58	25.9	1.018	19.7	2.5	
MKR 0967			90.5	3.56	25.9	1.020	20.8	2.0	113.0
MKR 1126			106.0	4.17	25.9	1.020	20.9	1.5	120.0
MKR 0924			91.0	3.58	26.0	1.024	24.0	1.5	
MKR 1136			91.0	3.58	26.1	1.028	21.0	1.5	150.0
MKR 1136			91.0	3.58	26.1	1.028	21.0	1.5	150.0
MKR 0955			153.5	6.04	26.1	1.028	40.4	2.0	
MKR 0925			121.0	4.76	26.2	1.031	28.5	2.0	
MKR 0859			152.0	5.98	26.4	1.039	42.0	2.0	113.0
MKR 0849			186.0	7.32	27.5	1.083	31.3	3.0	137.0
MKR 0857			194.0	7.64	27.5	1.083	32.3	3.0	
MKR 0774			185.0	7.28	27.7	1.091	46.0	2.5	118.0

30 mm ≤ Hals/Neck ø < 35 mm

MKR 0936			133.4	5.25	30.7	1.209	33.8	3.0	
MKR 0880	131.6	5.18		0.00	30.7	1.209	34.0	3.0	

Materialien/Materials

Zellulose, Kunststoffe, Glasfaser
Cellulose, plastics, fiberglass

Optionen/Options

luftgetrocknet, hartverpresst, Farbe
air dried, pressed, color

N = Nawi-Kegel / Nawi cone
K = Konvex-Kegel / Convex cone

E

Membrankegel, rund Cone bodies, round

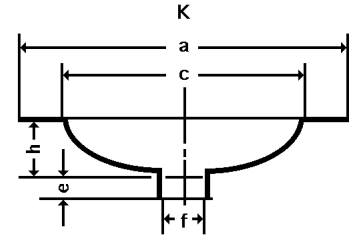
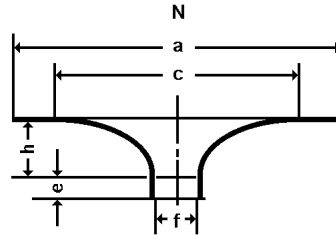
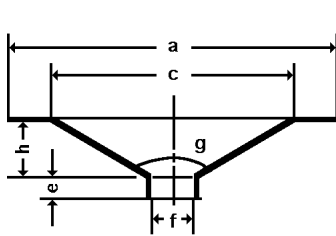

TYPE	Aussendurchmesser Outside diameter a mm inches	Basisdurchmesser Base diameter c mm inches	Halsdurchmesser Neck diameter f mm inches	Höhe ohne Hals Height w/o neck h mm	Hals- höhe Neck height e mm	Klebe- winkel Glueing angle Grad/Degrees
------	---	---	--	--	--	--

35 mm ≤ Hals/Neck ø < 40 mm

MKR 0858		154.0	6.06	37.5	1.476	39.0	1.5	112.0	
MKR 1060		163.0	6.42	37.5	1.476	38.5	2.5	117.0	
MKR 1061		195.0	7.68	37.5	1.476	48.3	2.5	117.0	
MKR 1118	200.0	7.87	195.0	7.68	37.5	1.476	48.3	2.5	117.0
MKR 0963		185.0	7.28	37.7	1.482	50.6	3.0	112.0	
MKR 1099	225.0	8.86		0.00	37.7	1.482	52.8	2.6	120.0
MKR 1048		152.0	5.98	37.8	1.488	35.8	2.5		
MKR 0941		152.2	5.99	37.8	1.488	36.3	3.0		
MKR 1013		185.0	7.28	37.8	1.488	48.7	3.0	113.0	
MKR 1006		240.0	9.45	37.8	1.488	67.5	3.0	112.0	
MKR 1085		240.0	9.45	37.8	1.488	65.0	3.0	115.0	
MKR 0873	149.6	5.89		0.00	37.8	1.488	37.5	3.0	
MKR 1113		121.0	4.76	38.0	1.496	28.8	3.0	112.0	
MKR 0829		182.0	7.17	38.0	1.496	36.0	2.0		
MKR 1124	190.0	7.48	185.0	7.28	38.0	1.496	51.0	3.0	112.0
MKR 0973		182.0	7.17	38.1	1.500	44.5	3.0		
MKR 1161		153.5	6.04	38.2	1.504	36.0	2.0	250.0	
MKR 0933		182.0	7.17	38.3	1.506	45.0	3.0		
MKR 0779		184.4	7.26	38.3	1.506	21.2	2.5	147.0	

40 mm ≤ Hals/Neck ø < 50 mm

MKR 1217	121.0	4.76			49.3	1.941	24.027.5	3.5	
----------	-------	------	--	--	------	-------	----------	-----	--

Hals/Neck ø ≥ 50mm

MKR 0994		152.0	5.98	50.8	2.000	36.0	3.0	110.0
MKR 1050		184.5	7.26	51.0	2.008	46.7	3.0	110.0
MKR 1062		70.0	2.76	51.1	2.012	9.8	0.8	
MKR 1041		240.0	9.45	51.1	2.012	76.5	3.5	

Materialien/Materials

Zellulose, Kunststoffe, Glasfaser
Cellulose, plastics, fiberglass

Optionen/Options

luftgetrocknet, hartverpresst, Farbe
air dried, pressed, color

N = Nawi-Kegel / Nawi cone
K = Konvex-Kegel / Convex cone

F

Membrankegel, oval Oval cone bodies

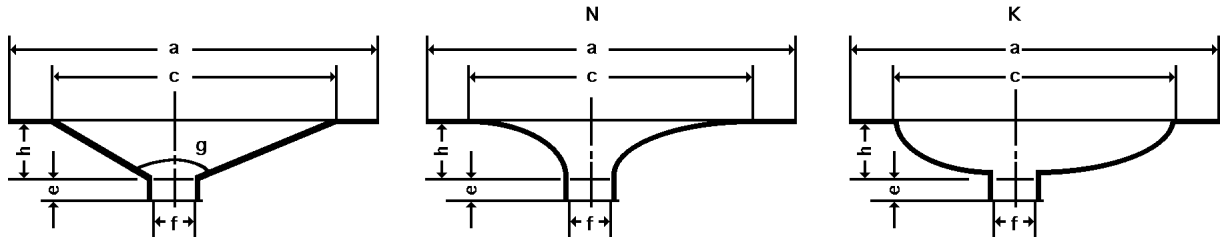

TYPE	Aussendurchmesser Outside diameter a mm inches	Basisdurchmesser Base diameter c mm inches	Halsdurchmesser Neck diameter f mm inches	Höhe ohne Hals Height w/o neck h mm	Hals- höhe Neck height e mm	Klebe- winkel Glueing angle Grad/Degrees
------	---	---	--	--	--	--

12 mm ≤ Hals/Neck ø < 14 mm

MKO 1096		130.0 x 53.0	5.12 x 2.09	12.5 0.490	24.0 1.5	156 / 115
----------	--	--------------	-------------	------------	----------	-----------

14 mm ≤ Hals/Neck ø < 16 mm

MKO 1134	132.0 x 52.5 5.20 x 2.07	130.0 x 51.1	5.12 x 2.01	15.6 0.614	20.0 1.0	145 / 77
----------	--------------------------	--------------	-------------	------------	----------	----------

16 mm ≤ Hals/Neck ø < 18 mm

MKO 1065		125.1 x 69.4	4.93 x 2.73	16.5 0.650	19.0 1.5	142 / 109
MKO 1114		130.0 x 70.0	5.12 x 2.76	17.2 0.677	16.8 2.0	
MKO 1110		131.0 x 70.5	5.16 x 2.78	17.2 0.677	16.8	148 / 115

18 mm ≤ Hals/Neck ø < 20 mm

MKO 1038		147.4 x 91.9	5.80 x 3.62	19.5 0.768	27.2 1.5	
----------	--	--------------	-------------	------------	----------	--

Materialien/Materials

Zellulose, Kunststoffe, Glasfaser
Cellulose, plastics, fiberglass

Optionen/Options

luftgetrocknet, hartverpresst, Farbe
air dried, pressed, color

N = Nawi-Kegel / Nawi cone
K = Konvex-Kegel / Convex cone

G

Hochtonkegel Tweeter cones

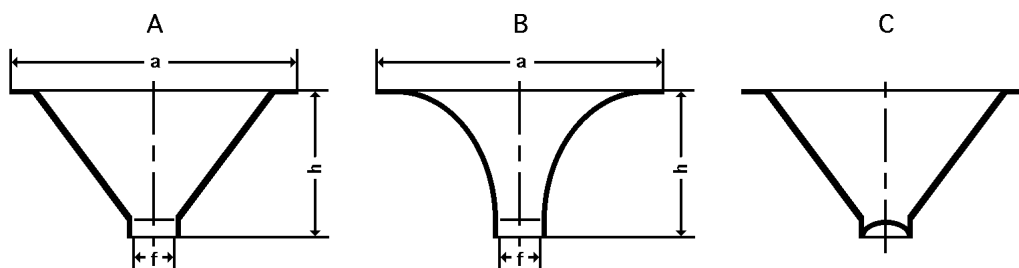

TYPE	Aussendurchmesser		Schwingspulen- durchmesser (Hals)		Höhe mit Hals	Form
	Outside diameter		Bobbin diameter		Height incl. neck	Form
	a		f		h	
	mm	inches	mm	inches	mm	

14 mm ≤ Hals/Neck ø < 16 mm

HTK 0921	45.0	1.77	14.4	0.567	19.5	A
----------	------	------	------	-------	------	---

16 mm ≤ Hals/Neck ø < 18 mm

HTK 0751	47.0	1.85	16.2	0.638	17.5	A
HTK 0513	51.0	2.01	16.2	0.638	27.0	—
HTK 0968	57.0	2.24	16.2	0.638	29.5	C
HTK 0415	59.0	2.32	16.2	0.638	17.5	—

18 mm ≤ Hals/Neck ø < 20 mm

HTK 0881	34.0	1.34	19.2	0.756	19.0	C
HTK 0915	49.0	1.93	19.2	0.756	27.5	A
HTK 0516	72.0	2.83	19.3	0.760	21.5	—
HTK 0898	50.0	1.97	19.8	0.780	23.5	B

25 mm ≤ Hals/Neck ø < 30 mm

HTK 0839	60.0	2.36	25.4	1.000	26.5	A
HTK 0840	64.0	2.52	25.4	1.000	26.5	A
HTK 1046	52.0	2.05	26.0	1.024	10.0	A
HTK 0483	89.0	3.50	26.5	1.043	40.0	A
HTK 0450	100.0	3.94	29.8	1.173	64.0	B

30 mm ≤ Hals/Neck ø < 35 mm

HTK 0343	83.0	3.27	30.0	1.181	64.0	A
----------	------	------	------	-------	------	---

35 mm ≤ Hals/Neck ø < 40 mm

HTK 0923	100.0	3.94	36.5	1.437	47.5	B
HTK 0932	100.0	3.94	37.8	1.488	41.5	A

Materialien/Materials

Zellulose
Cellulose

Optionen/Options

Farbe
Color

G

Hochtonkegel Tweeter cones

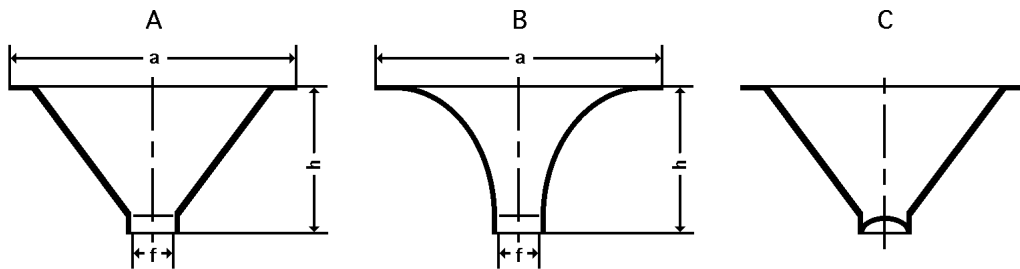

TYPE	Aussendurchmesser	Schwingspulen- durchmesser (Hals)	Höhe mit Hals	Form
	Outside diameter	Bobbin diameter	Height incl. neck	Form
	a	f	h	
	mm inches	mm inches	mm	

40 mm ≤ Hals/Neck ø < 50 mm

HTK 0948	116.0	4.57	42.0	1.654	50.0	A	
HTK 0855	85.0	3.35	44.3	1.744	45.0	A	

Materialien/Materials

Zellulose
Cellulose

Optionen/Options

Farbe
Color

H

Kalottenmembranen Dome diaphragms

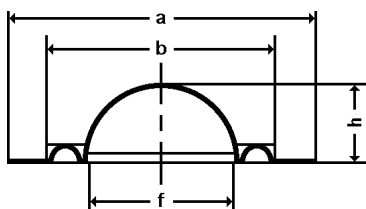

TYPE	Aussendurchmesser		Einspann- durchmesser	Schwingspulen- durchmesser (Hals)		Höhe
	Outside diameter			Clamping diameter	Bobbin diameter	
	a		b		f	
	mm	inches	mm	mm	inches	mm
KMR 0096	32.0	1.26	25.6			5.1
12 mm ≤ Schwingspulen/swing coil						
KMR 0070	32.0	1.26	15.2	12.2	0.480	4.5
14 mm ≤ Schwingspulen/swing coil						
KMR 0085	22.8	0.90		14.9	0.587	4.0
16 mm ≤ Schwingspulen/swing coil						
KMR 0072	31.0	1.22	21.7	16.3	0.642	4.5
KMR 0033	31.0	1.22	24.3	16.3	0.642	4.4
18 mm ≤ Schwingspulen/swing coil						
KMR 0081	34.0	1.34	23.8	18.4	0.722	5.0
KMR 0031	45.0	1.77		19.3	0.760	6.1
KMR 0060	60.0	2.36	24.4	19.4	0.764	5.1
KMR 0078	54.0	2.13	25.0	19.5	0.768	5.6
KMR 0082	54.0	2.13	25.6	19.5	0.768	5.0
KMR 0050	55.0	2.17	25.8	19.5	0.768	5.3
KMR 0080	82.0	3.23	25.8	19.5	0.768	5.3
KMR 0077	34.0	1.34	25.0	19.6	0.772	7.1
KMR 0023	60.0	2.36	23.6	19.7	0.776	6.1
25 mm ≤ Schwingspulen/swing coil						
KMR 0059	60.0	2.36	31.0	25.4	1.000	8.3
KMR 0086	38.5	1.52	31.8	25.5	1.004	7.8
KMR 0066	42.0	1.65	31.4	25.5	1.004	5.8
KMR 0017	55.0	2.17		25.5	1.004	8.4
KMR 0037	55.0	2.17	31.8	25.5	1.004	7.2

Materialien/Materials

Polyester, Kunststoffolien
Polyester, plastic foils

Optionen/Options

Farbe, unbeschichtet, beschichtet
Color, coated, uncoated

H

Kalottenmembranen Dome diaphragms

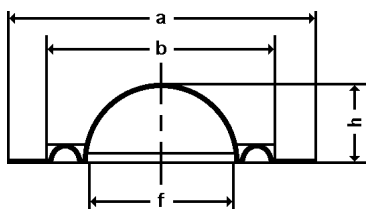

TYPE	Aussendurchmesser		Einspann- durchmesser	Schwingspulen- durchmesser (Hals)		Höhe
	Outside diameter			Clamping diameter	Bobbin diameter	
	a		b		f	
	mm	inches	mm	mm	inches	mm
KMR 0049	55.0	2.17	31.8	25.5	1.004	8.3
KMR 0051	55.0	2.17	31.8	25.5	1.004	7.0
KMR 0029	60.0	2.36	31.4	25.5	1.004	8.6
KMR 0054	90.0	3.54	49.5	25.5	1.004	7.2
KMR 0067	38.0	1.50	32.2	25.6	1.008	7.2
KMR 0076	40.0	1.57	30.4	25.6	1.008	9.0
KMR 0043	42.0	1.65	31.4	25.6	1.008	8.6
KMR 0035	60.0	2.36	31.0	25.6	1.008	8.3
KMR 0083	41.0	1.61	32.0	25.7	1.010	7.1
KMR 0024	38.0	1.50	31.5	25.7	1.012	7.5
KMR 0073	38.0	1.50	32.2	25.7	1.012	5.5
35 mm ≤ Schwingspulen/swing coil						
KMR 0022	70.0	2.76		37.5	1.476	12.7
KMR 0084	55.0	2.17	48.0	37.6	1.478	13.0
KMR 0061	78.0	3.07	48.0	37.6	1.478	13.0
KMR 0047	80.0	3.15	48.0	37.7	1.484	13.6
KMR 0055	60.0	2.36	52.6	37.8	1.488	11.9
KMR 0071	60.0	2.36	52.6	37.8	1.488	11.9
KMR 0039	54.0	2.13	47.4	38.2	1.504	10.0
KMR 0045	55.0	2.17	49.0	38.2	1.504	11.2
KMR 0069	55.0	2.17	49.0	38.2	1.504	11.0
KMR 0040	58.0	2.28	53.0	38.2	1.504	9.5
KMR 0032	60.0	2.36	53.0	38.2	1.504	12.4
40 mm ≤ Schwingspulen/swing coil						
KMR 0057	80.0	3.15	59.0	45.7	1.799	14.0
Schwingspulen/swing coil ø ≥						
KMR 0075	72.0	2.83	63.8	50.6	1.992	15.2
KMR 0062	95.0	3.74	63.8	50.8	2.000	14.0
KMR 0056	95.0	3.74	63.8	50.8	2.000	17.0
KMR 0034	110.0	4.33	63.7	50.8	2.000	14.0

Materialien/Materials

Polyester, Kunststoffolien
Polyester, plastic foils

Optionen/Options

Farbe, unbeschichtet, beschichtet
Color, coated, uncoated

H

Kalottenmembranen Dome diaphragms

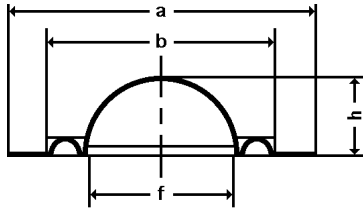

TYPE	Aussendurchmesser		Einspann- durchmesser	Schwingspulen- durchmesser (Hals)		Höhe
	Outside diameter		Clamping diameter	Bobbin diameter		Height
	a		b	f		h
	mm	inches	mm	mm	inches	mm
KMR 0052	110.0	4.33	63.8	50.8	2.000	14.0
KMR 0036	110.0	4.33	68.0	50.8	2.000	14.0
KMR 0027	110.0	4.33	68.0	50.8	2.000	17.0
KMR 0058	95.0	3.74	63.8	50.9	2.002	14.0
KMR 0079	97.0	3.82	63.7	50.9	2.002	14.0
KMR 0048	54.0	2.13		51.3	2.020	13.1
KMR 0028	120.0	4.72	80.0	62.0	2.441	20.0

Materialien/Materials

Polyester, Kunststoffolien
Polyester, plastic foils

Optionen/Options

Farbe, unbeschichtet, beschichtet
Color, coated, uncoated

Flachzentrierungen Flat spiders (suspensions)

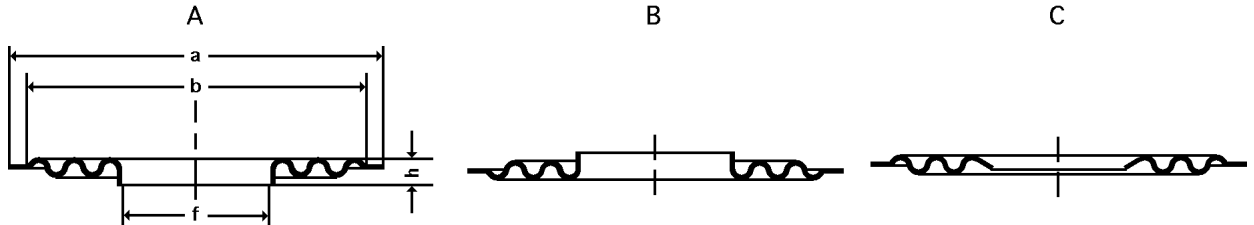

TYPE	Aussendurchmesser Outside diameter a mm inches	Einspann- durchmesser Clamping diameter b mm	Halsdurchmesser Neck diameter f mm inches	Höhe ohne Hals Height w/o neck h mm	Halsform Neck form
------	---	--	--	--	-----------------------

12 mm ≤ Hals/Neck ø < 14 mm

FZ 0338	61.0 2.40	54.6	12.8 0.504	2.0	C
FZ 0120	49.0 1.93	40.0	12.9 0.508	1.6	A
FZ 0234	50.0 1.97	38.0	12.9 0.508	2.3	C
FZ 0081	39.0 1.54	37.0	13.1 0.516	1.7	A
FZ 0111	39.0 1.54	37.0	13.1 0.516	1.7	A
FZ 0100	50.0 1.97	38.0	13.2 0.520	2.0	C
FZ 0336	65.0 2.56	54.6	13.3 0.524	1.8	C

14 mm ≤ Hals/Neck ø < 16 mm

FZ 0283	30.0 1.18	26.6	14.0 0.551	1.5	A
---------	-----------	------	------------	-----	---

16 mm ≤ Hals/Neck ø < 18 mm

FZ 0416	60.0 2.36	54.6	16.6 0.654	1.0	A
FZ 0167	46.0 1.81	39.3	17.0 0.669	2.1	A
FZ 0353	61.0 2.40	54.6	17.0 0.669	2.0	A
FZ 0387	57.8 2.28	52.8	17.1 0.673	1.5	A
FZ 0394	60.0 2.36	54.6	17.1 0.673	1.9	A
FZ 0190	75.0 2.95	66.0	17.2 0.677	3.0	A
FZ 0301	46.0 1.81	38.0	17.3 0.681	1.2	C
FZ 0345	60.0 2.36	54.6	17.3 0.681	2.1	C
FZ 0331	65.0 2.56	56.0	17.5 0.689	1.8	C

18 mm ≤ Hals/Neck ø < 20 mm

FZ 0492	75.0 2.95	66.0	19.8 0.780	1.8 1.5	
---------	-----------	------	------------	---------	--

20 mm ≤ Hals/Neck ø < 25 mm

FZ 0204	59.0 2.32	54.0	20.0 0.787	1.6	A
FZ 0232	74.0 2.91	63.1	20.1 0.791	3.0	A
FZ 0113	78.0 3.07	66.0	20.1 0.791	1.8	A

Materialien/Materials

Baumwolle, Baumwolle/Kunstfaser, Kunstfaser, Nomex
Cotton, Cotton/Synthetic blends, Synthetics, Nomex

Optionen/Options

Farbe, feuerhemmend
Color, fire retardant

Flachzentrierungen Flat spiders (suspensions)

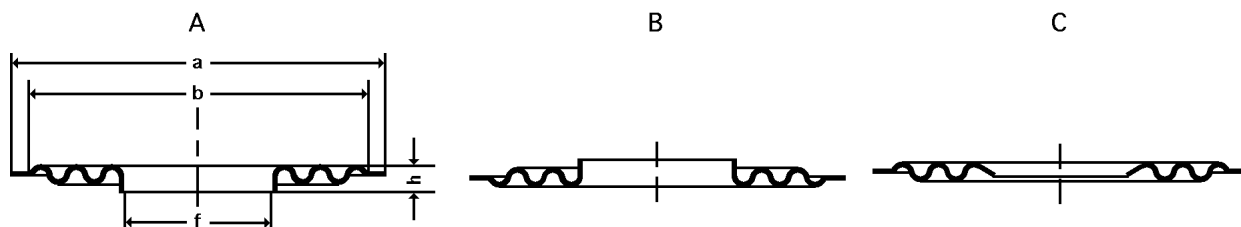

TYPE	Aussendurchmesser		Einspann- durchmesser	Halsdurchmesser		Höhe ohne Hals	Halsform
	Outside diameter			Clamping diameter	Neck diameter		
	a		b		f	h	
	mm	inches	mm	mm	inches	mm	
FZ 0154	78.0	3.07	66.0	20.1	0.791	2.3	A
FZ 0156	78.0	3.07	66.0	20.1	0.791	2.3	A
FZ 0018	80.0	3.15	66.0	20.1	0.791	2.0	A
FZ 0341	63.0	2.48	58.0	20.2	0.795	1.8	A
FZ 0159	68.0	2.68	54.0	20.2	0.795	2.2	A
FZ 0102	75.0	2.95	57.8	20.2	0.795	2.0	A
FZ 0412	56.5	2.22	49.8	20.3	0.799	1.5	C
FZ 0196	65.0	2.56	56.0	20.3	0.799	1.6	C
FZ 0222	65.0	2.56	56.0	20.3	0.799	1.3	C
FZ 0310	65.0	2.56	56.0	20.3	0.799	1.8	C
FZ 0313	65.0	2.56	56.0	20.3	0.799	1.3	C
FZ 0374	65.0	2.56	56.0	20.3	0.799	2.5	C
FZ 0067	76.0	2.99	56.0	20.3	0.799	3.0	C
FZ 0071	87.0	3.43	65.0	20.3	0.799	3.2	A
FZ 0349	92.0	3.62	83.0	20.3	0.799	3.4	A
FZ 0362	92.0	3.62	83.0	20.3	0.799	2.3	A
FZ 0146	75.0	2.95	62.4	20.4	0.803	3.5	A
FZ 0229	75.0	2.95	64.0	20.4	0.803	2.2	A
FZ 0231	75.0	2.95	64.0	20.4	0.803	2.2	A
FZ 0176	80.0	3.15	66.6	20.4	0.803	2.2	A
FZ 0087	90.0	3.54	78.0	20.4	0.803		A
FZ 0361	108.0	4.25	97.0	20.4	0.803	2.5	A
FZ 0418	71.5	2.81	62.4	20.5	0.807	1.1	C
FZ 0358	71.5	2.81	65.0	20.5	0.807	2.2	C
FZ 0295	71.5	2.81	65.0	20.5	0.807	2.5	A
FZ 0441	75.0	2.95	67.5	20.7	0.815	2.0	A
FZ 0206	64.0	2.52	47.2	20.8	0.819	2.0	B
FZ 0002	68.0	2.68	52.8	20.8	0.819	2.7	A
FZ 0472	75.0	2.95	66.0	21.0	0.827	1.6	A
FZ 0432	56.5	2.22	49.8	21.3	0.839	0.7	A
FZ 0432	56.5	2.22	49.8	21.3	0.839	0.7	A
FZ 0110	71.0	2.80	55.0	21.6	0.850	2.4	C
FZ 0225	56.0	2.20	47.2	22.2	0.874	1.2	A
FZ 0185	75.0	2.95	67.5	22.6	0.890	2.3	C

Materialien/Materials

Baumwolle, Baumwolle/Kunstfaser, Kunstfaser, Nomex
Cotton, Cotton/Synthetic blends, Synthetics, Nomex

Optionen/Options

Farbe, feuerhemmend
Color, fire retardant

Flachzentrierungen Flat spiders (suspensions)

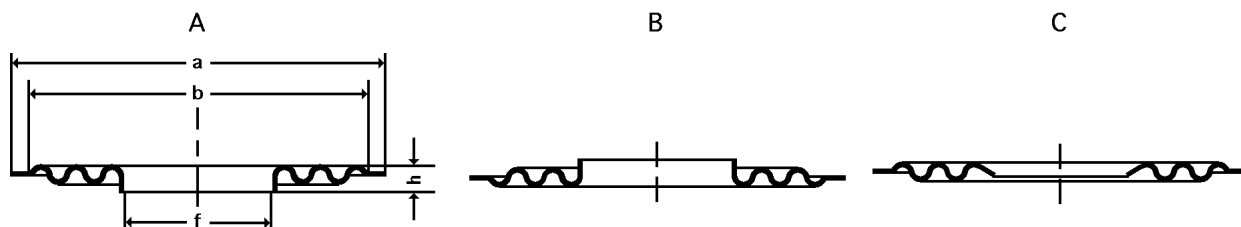

TYPE	Aussendurchmesser		Einspann- durchmesser	Halsdurchmesser		Höhe ohne Hals	Halsform
	Outside diameter			Clamping diameter	Neck diameter		
	a		b		f	h	

	mm	inches	mm	mm	inches	mm	
FZ 0314	75.0	2.95	67.5	22.6	0.890	2.3	C
FZ 0285	105.0	4.13	90.0	22.6	0.891	3.2	C
FZ 0125	75.0	2.95	67.5	22.6	0.891	2.3	C
FZ 0302	79.0	3.11	70.0	22.8	0.898	1.8	C

25 mm ≤ Hals/Neck ø < 30 mm

FZ 0098	80.0	3.15	66.0	25.8	1.016	4.4	A
FZ 0420	92.0	3.62	83.0	25.8	1.016	1.8	C
FZ 0061	85.0	3.35	66.0	26.0	1.024	1.8	A
FZ 0478	90.0	3.54	83.0	26.1	1.028	2.3 2.3	
FZ 0124	79.0	3.11	73.1	26.3	1.036	2.0	C
FZ 0097	80.0	3.15	66.0	26.4	1.039	4.4	A
FZ 0147	101.0	3.98	87.0	26.5	1.043	5.8	A
FZ 0024	98.0	3.86	75.6	26.6	1.047	3.2	A
FZ 0303	108.0	4.25	99.3	26.7	1.051	2.5	A
FZ 0326	115.0	4.53	97.0	26.8	1.055	2.8	A
FZ 0354	73.0	2.87	68.4	26.9	1.059	2.0	A
FZ 0356	92.0	3.62	83.0	26.9	1.059	2.0	A
FZ 0442	75.0	2.95	68.0	27.1	1.067	1.7	A
FZ 0442	75.0	2.95	68.0	27.1	1.067	1.7	A
FZ 0457	113.0	4.45	104.0	27.1	1.067	3.3	A
FZ 0422	73.0	2.87	68.4	27.2	1.071	1.7	A
FZ 0479	76.0	2.99	66.7	27.2	1.071	2.5 0.5	
FZ 0123	79.0	3.11	73.2	27.2	1.072	2.3	C
FZ 0149	100.0	3.94	80.0	28.4	1.118	2.9	C
FZ 0025	98.0	3.86	84.0	28.6	1.126	4.5	A

35 mm ≤ Hals/Neck ø < 40 mm

FZ 0070	110.0	4.33	100.0	38.6	1.520	3.5	C
FZ 0456	135.0	5.31	120.0	39.0	1.535	1.2	A

40 mm ≤ Hals/Neck ø < 50 mm

FZ 0273	110.0	4.33	98.2	40.3	1.587	4.1	A
---------	-------	------	------	------	-------	-----	---

Materialien/Materials

Baumwolle, Baumwolle/Kunstfaser, Kunstfaser, Nomex
Cotton, Cotton/Synthetic blends, Synthetics, Nomex

Optionen/Options

Farbe, feuerhemmend
Color, fire retardant



Flachzentrierungen Flat spiders (suspensions)

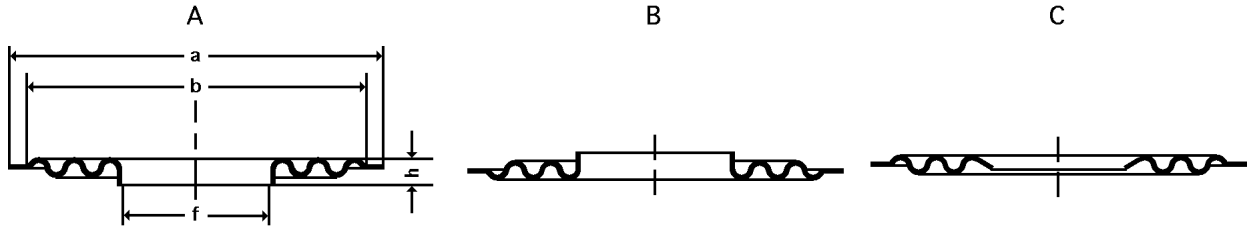

TYPE	Aussendurchmesser		Einspanndurchmesser	Halsdurchmesser		Höhe ohne Hals	Halsform
	Outside diameter			Clamping diameter	Neck diameter		
	a		b		f	h	
	mm	inches	mm	mm	inches	mm	
FZ 0236	122.0	4.80	110.0	40.6	1.598	3.0	C
Hals/Neck $\varnothing \geq 50\text{mm}$							
FZ 0319	75.0	2.95	66.9	50.9	2.004	2.0	B
FZ 0320	75.0	2.95	66.9	50.9	2.004	2.0	B
FZ 0393	98.0	3.86	91.0	51.8	2.039	1.5	C
FZ 0212	145.0	5.71	125.0	65.0	2.559	2.0	A
FZ 0449	145.0	5.71	130.0	65.3	2.571	2.5	A

Materialien/Materials

Baumwolle, Baumwolle/Kunstfaser, Kunstfaser, Nomex
Cotton, Cotton/Synthetic blends, Synthetics, Nomex

Optionen/Options

Farbe, feuerhemmend
Color, fire retardant

J

Topfzentrierungen Cup spiders

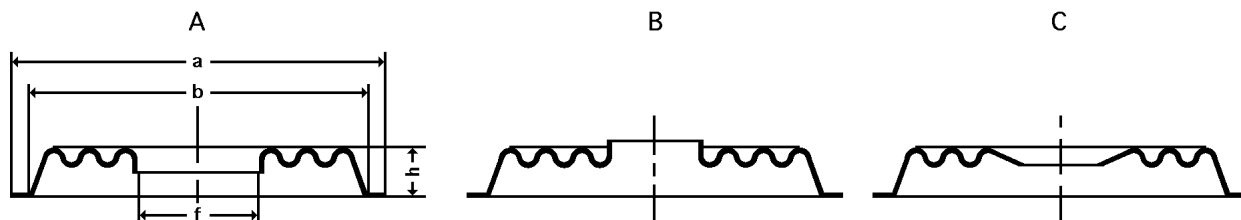

TYPE	Aussendurchmesser Outside diameter	Einspann- durchmesser Clamping diameter	Halsdurchmesser Neck diameter	Höhe ohne Hals Height w/o neck	Halsform Neck form
	a	b	f	h	
	mm inches	mm	mm inches	mm	

Hals/Neck $\varnothing < 10$ mm

TZ 0133	24.8	0.98	22.8	9.7	0.382	2.2	A
TZ 0134	24.8	0.98	22.8	9.7	0.382	2.2	A

12 mm \leq Hals/Neck $\varnothing < 14$ mm

TZ 0248	29.0	1.14	27.0	12.0	0.472	2.7	C
TZ 0117	28.4	1.12	26.0	12.1	0.476	3.3	C
TZ 0158	20.0	0.79	19.0	12.4	0.488	1.8	A
TZ 0140	24.8	0.98	22.3	12.4	0.488	2.2	A
TZ 0173	28.5	1.12	25.2	12.4	0.488	4.4	C
TZ 0253	28.5	1.12	25.2	12.4	0.488	4.3	A
TZ 0161	20.0	0.79	19.0	12.6	0.496	1.6	A
TZ 0162	24.8	0.98	22.3	12.6	0.496	2.2	A
TZ 0155	27.0	1.06	24.0	12.6	0.496	3.0	A
TZ 0193	32.0	1.26	29.0	12.8	0.504	2.6	A
TZ 0330	34.0	1.34	30.7	12.8	0.504	4.9	C
TZ 0132	24.7	0.97	22.7	12.9	0.508	2.7	A
TZ 0181	25.5	1.00	23.9	12.9	0.508	3.7	C
TZ 0359	46.0	1.81	40.0	12.9	0.508	5.3	A
TZ 0281	46.0	1.81	40.3	12.9	0.508	4.4	A
TZ 0128	28.8	1.13	25.0	13.0	0.512	3.0	C
TZ 0208	30.0	1.18	26.0	13.0	0.512	3.9	A
TZ 0175	34.1	1.34	31.3	13.0	0.512	2.5	A
TZ 0115	29.4	1.16	26.4	13.1	0.516	2.9	C
TZ 0282	29.4	1.16	26.4	13.1	0.516	2.5	C
TZ 0340	29.4	1.16	26.4	13.1	0.516	1.6	C
TZ 0170	34.0	1.34	31.3	13.1	0.516	6.0	A
TZ 0279	34.1	1.34	31.7	13.1	0.516	3.5	A
TZ 0328	36.0	1.42	32.0	13.1	0.516	4.7	A
TZ 0130	40.0	1.57	35.8	13.1	0.516	4.9	C
TZ 0267	49.0	1.93	46.0	13.2	0.520	2.8	A
TZ 0219	30.0	1.18	28.0	13.3	0.524	3.2	A

Materialien/Materials

Baumwolle, Baumwolle/Kunstfaser, Kunstfaser, Nomex
Cotton, Cotton/Synthetic blends, Synthetics, Nomex

Optionen/Options

Farbe, feuerhemmend
Color, fire retardant

J

Topfzentrierungen Cup spiders

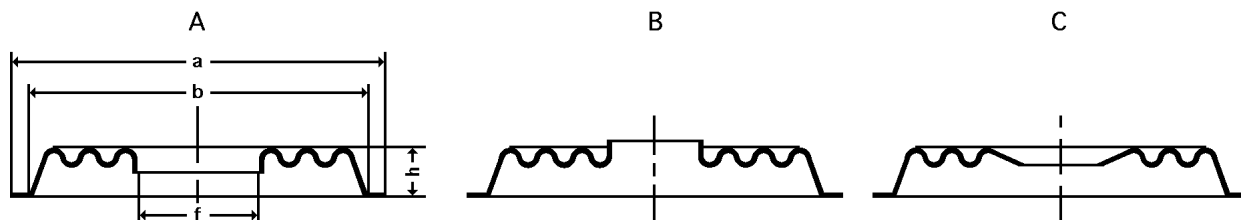

TYPE	Aussendurchmesser		Einspann- durchmesser	Halsdurchmesser		Höhe ohne Hals	Halsform
	Outside diameter			Clamping diameter	Neck diameter		
	a		b		f	h	

	mm	inches	mm	mm	inches	mm	
TZ 0172	38.0	1.50	34.0	13.5	0.531	4.0	C
TZ 0084	38.0	1.50	34.0	13.5	0.531	4.0	C
TZ 0466	33.5	1.32	30.0	13.6	0.535	2.8	A
TZ 0277	28.4	1.12	26.0	13.7	0.539	3.3	C
TZ 0137	40.0	1.57	35.8	13.7	0.539	4.5	C
TZ 0329	30.0	1.18	28.0	13.9	0.547	2.5	A

14 mm ≤ Hals/Neck ø < 16 mm

TZ 0280	30.0	1.18	27.1	14.1	0.555	3.3	A
TZ 0275	46.0	1.81	43.0	14.5	0.571	4.0	C
TZ 0256	46.5	1.83	45.0	14.5	0.571	5.0	A
TZ 0272	47.0	1.85	43.6	14.5	0.571	4.0	C
TZ 0434	49.0	1.93	46.0	14.5	0.571	5.4	A
TZ 0106	29.0	1.14	26.4	14.6	0.575	2.9	C
TZ 0477	38.2	1.50	36.2	14.6	0.575	2.3 0.9	
TZ 0188	29.5	1.16	29.5	14.7	0.579	3.0	A
TZ 0250	44.0	1.73	42.0	14.7	0.579	3.7	A
TZ 0445	45.0	1.77	43.0	14.7	0.579	4.0	A
TZ 0433	45.0	1.77	44.0	14.7	0.579	4.7	C
TZ 0228	38.0	1.50	36.0	14.8	0.583	2.0	C
TZ 0227	40.0	1.57	38.0	14.8	0.583	3.0	C
TZ 0226	45.0	1.77	43.5	14.8	0.583	4.0	C
TZ 0274	48.0	1.89	43.0	14.8	0.583	5.5	A
TZ 0251	39.6	1.56	37.3	14.9	0.585	3.6	A
TZ 0245	52.0	2.05	51.0	14.9	0.587	8.5	A
TZ 0259	38.0	1.50	35.2	15.0	0.591	5.5	A
TZ 0214	38.0	1.50	36.0	15.0	0.591	2.0	C
TZ 0414	46.0	1.81	40.3	15.0	0.591	8.2	A
TZ 0443	46.0	1.81	40.3	15.0	0.591	7.2	A
TZ 0258	42.5	1.67	37.5	15.2	0.598	5.5	A
TZ 0217	3.0	0.12	28.0	15.5	0.610	3.2	A
TZ 0218	40.0	1.57	37.0	15.5	0.610	4.5	A
TZ 0203	44.5	1.75	40.9	15.5	0.610	2.0	A

Materialien/Materials

Baumwolle, Baumwolle/Kunstfaser, Kunstfaser, Nomex
Cotton, Cotton/Synthetic blends, Synthetics, Nomex

Optionen/Options

Farbe, feuerhemmend
Color, fire retardant

J

Topfzentrierungen Cup spiders

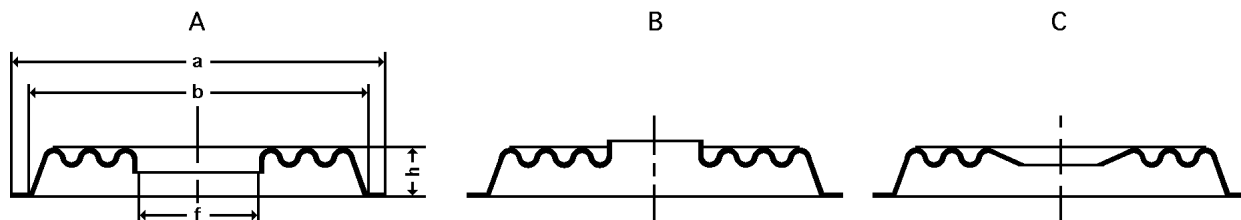

TYPE	Aussendurchmesser		Einspann- durchmesser	Halsdurchmesser		Höhe ohne Hals	Halsform
	Outside diameter		Clamping diameter	Neck diameter		Height w/o neck	Neck form
	a		b	f		h	
	mm	inches	mm	mm	inches	mm	

TZ 0205	45.0	1.77	43.0	15.5	0.610	5.4	A
TZ 0260	30.0	1.18	28.0	15.7	0.618	3.2	A
TZ 0436	39.0	1.54	34.7	15.7	0.618	4.4	A
TZ 0233	44.0	1.73	40.0	15.7	0.618	3.5	A
TZ 0244	46.0	1.81	43.0	15.9	0.626	5.0	A

16 mm ≤ Hals/Neck ø < 18 mm

TZ 0428	49.0	1.93	44.0	16.0	0.630	4.0	A
TZ 0240	45.0	1.77	41.2	16.2	0.638	4.2	A
TZ 0103	45.0	1.77	40.0	16.5	0.650	5.0	A
TZ 0271	43.0	1.69	41.0	16.6	0.654	4.5	A
TZ 0410	60.0	2.36	54.6	16.6	0.654	2.6	A
TZ 0402	47.5	1.87	44.0	16.7	0.657	1.8	C
TZ 0347	36.0	1.42	58.6	17.0	0.669	2.6	A
TZ 0107	44.0	1.73	40.5	17.0	0.669	4.5	C
TZ 0312	46.0	1.81	41.0	17.0	0.669	4.0	A
TZ 0221	47.0	1.85	43.0	17.0	0.669	4.5	C
TZ 0083	51.0	2.01	45.0	17.0	0.669	4.0	C
TZ 0105	64.0	2.52	59.8	17.0	0.669	3.9	A
TZ 0389	57.8	2.28	52.8	17.1	0.673	2.5	A
TZ 0409	57.8	2.28	52.8	17.1	0.673	2.1	A
TZ 0371	60.0	2.36	54.6	17.1	0.673	2.9	A
TZ 0398	60.0	2.36	54.6	17.1	0.673	5.2	A
TZ 0407	60.0	2.36	54.6	17.1	0.673	6.0	A
TZ 0298	75.0	2.95	69.1	17.1	0.673	3.0	A
TZ 0171	34.0	1.34	31.6	17.2	0.677	4.3	A
TZ 0112	46.0	1.81	41.2	17.2	0.677	2.3	A
TZ 0209	46.0	1.81	42.5	17.2	0.677	4.8	A
TZ 0284	49.0	1.93	46.2	17.2	0.677	3.0	A
TZ 0079	50.0	1.97	46.0	17.2	0.677	4.8	A
TZ 0095	50.0	1.97	46.0	17.2	0.677	4.8	A
TZ 0104	50.0	1.97	46.2	17.2	0.677	2.8	A
TZ 0109	50.0	1.97	46.2	17.2	0.677	2.8	A

Materialien/Materials

Baumwolle, Baumwolle/Kunstfaser, Kunstfaser, Nomex
Cotton, Cotton/Synthetic blends, Synthetics, Nomex

Optionen/Options

Farbe, feuerhemmend
Color, fire retardant

J

Topfzentrierungen Cup spiders

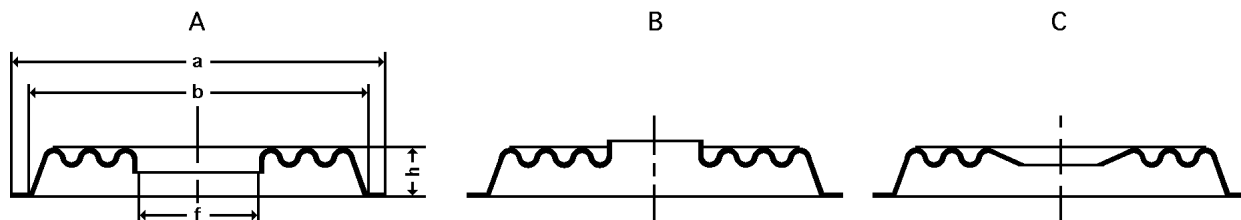

TYPE	Aussendurchmesser		Einspann- durchmesser	Halsdurchmesser		Höhe ohne Hals	Halsform
	Outside diameter			Clamping diameter	Neck diameter		
	a		b		f	h	
	mm	inches	mm	mm	inches	mm	
TZ 0122	50.0	1.97	46.2	17.2	0.677	2.8	A
TZ 0241	50.8	2.00	47.8	17.2	0.677	9.8	A
TZ 0194	51.0	2.01	45.3	17.2	0.677	4.5	C
TZ 0401	51.0	2.01	45.3	17.2	0.677	4.1	C
TZ 0080	58.2	2.29	54.2	17.2	0.677	4.1	A
TZ 0101	58.2	2.29	55.4	17.2	0.677	4.1	A
TZ 0064	58.2	2.29	55.4	17.2	0.677	3.5	A
TZ 0072	58.2	2.29	55.4	17.2	0.677	4.3	A
TZ 0072	58.2	2.29	55.4	17.2	0.677	4.1	A
TZ 0265	58.5	2.30	50.0	17.2	0.677	5.0	A
TZ 0291	63.0	2.48	60.2	17.2	0.677	3.1	A
TZ 0090	64.0	2.52	59.8	17.2	0.677	3.5	C
TZ 0375	71.0	2.80	63.0	17.2	0.677	2.0	A
TZ 0373	71.0	2.80	65.0	17.2	0.677	5.0	A
TZ 0238	50.8	2.00	47.8	17.3	0.679	5.8	C
TZ 0168	47.0	1.85	43.0	17.3	0.681	4.5	C
TZ 0192	50.0	1.97	47.0	17.3	0.681	6.7	A
TZ 0195	50.0	1.97	47.0	17.3	0.681	6.7	A
TZ 0055	50.0	1.97	47.0	17.3	0.681	6.7	A
TZ 0355	60.0	2.36	54.6	17.3	0.681	3.1	A
TZ 0152	61.0	2.40	57.5	17.3	0.681	3.7	A
TZ 0157	61.0	2.40	57.5	17.3	0.681	3.7	A
TZ 0163	61.0	2.40	57.5	17.3	0.681	7.7	A
TZ 0164	61.0	2.40	57.5	17.3	0.681	3.7	A
TZ 0057	63.0	2.48	58.6	17.3	0.681	3.7	C
TZ 0068	58.2	2.29	52.7	17.4	0.685	3.8	C
TZ 0254	46.0	1.81	42.4	17.6	0.691	1.7	A
TZ 0053	58.2	2.29	52.2	17.6	0.693	3.0	C
TZ 0261	40.0	1.57	37.0	17.8	0.701	4.5	A

18 mm ≤ Hals/Neck ø < 20 mm

TZ 0415	60.0	2.36	56.6	18.5	0.728	4.4	A
TZ 0257	48.0	1.89	43.0	19.0	0.748	4.5	A

Materialien/Materials

Baumwolle, Baumwolle/Kunstfaser, Kunstfaser, Nomex
Cotton, Cotton/Synthetic blends, Synthetics, Nomex

Optionen/Options

Farbe, feuerhemmend
Color, fire retardant

J

Topfzentrierungen Cup spiders

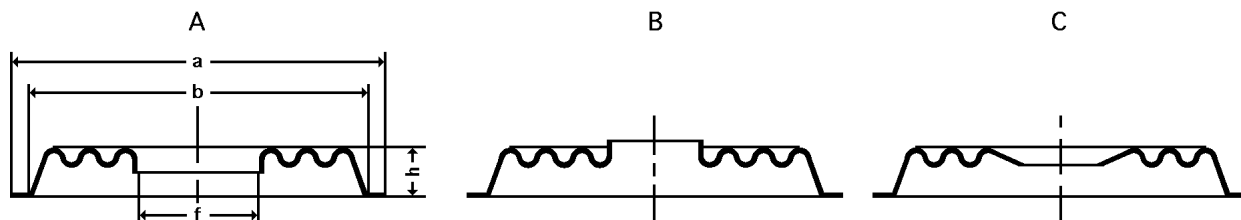

TYPE	Aussendurchmesser		Einspann- durchmesser	Halsdurchmesser		Höhe ohne Hals	Halsform
	Outside diameter			Clamping diameter	Neck diameter		
	a		b		f	h	
	mm	inches	mm	mm	inches	mm	

TZ 0290	52.0	2.05	45.0	19.5	0.768	2.0	C
TZ 0144	49.0	1.93	45.0	19.6	0.772	7.5	A
TZ 0150	51.5	2.03	44.9	19.6	0.772	7.5	A
TZ 0337	67.0	2.64	60.8	19.6	0.772	4.6	B
TZ 0093	44.0	1.73	40.5	19.7	0.776	4.5	A
TZ 0099	44.0	1.73	40.5	19.7	0.776	4.5	A
TZ 0255	52.0	2.05	48.0	19.7	0.776	7.0	A
TZ 0094	52.0	2.05	48.0	19.7	0.776	8.0	A
TZ 0444	59.0	2.32	56.0	19.7	0.776	4.0	A
TZ 0189	62.0	2.44	56.5	19.7	0.776	8.0	A
TZ 0119	62.0	2.44	57.6	19.7	0.776	8.0	A
TZ 0166	49.0	1.93	45.0	19.8	0.780	6.5	A
TZ 0473	52.0	2.05	48.0	19.8	0.780	3.0	C
TZ 0507	56.2	2.21	50.5	19.8	0.780	2.7 1.2	
TZ 0411	60.0	2.36	54.6	19.8	0.780	2.9	A
TZ 0121	61.8	2.43	57.8	19.8	0.780	5.6	C
TZ 0483	75.0	2.95	67.2	19.8	0.780	2.3 2.2	5.5

20 mm ≤ Hals/Neck ø < 25 mm

TZ 0074	51.0	2.01	46.6	20.0	0.787	5.3	A
TZ 0151	58.0	2.28	53.5	20.0	0.787	5.3	A
TZ 0342	63.0	2.48	59.0	20.0	0.787	3.3	A
TZ 0216	67.0	2.64	60.8	20.0	0.787	3.3	A
TZ 0220	67.0	2.64	60.8	20.0	0.787	3.3	A
TZ 0182	69.0	2.72	64.0	20.0	0.787	8.3	A
TZ 0378	71.0	2.80	65.4	20.0	0.787	5.4	A
TZ 0403	71.0	2.80	65.4	20.0	0.787	5.4	A
TZ 0191	72.0	2.83	66.5	20.0	0.787	7.9	A
TZ 0207	76.0	2.99	70.5	20.0	0.787	3.5	A
TZ 0246	61.0	2.40	56.7	20.1	0.791	4.6	A
TZ 0073	58.2	2.29	54.4	20.2	0.795	3.8	A
TZ 0333	62.0	2.44	57.0	20.2	0.795	8.0	A
TZ 0237	63.0	2.48	57.0	20.2	0.795	3.7	A

Materialien/Materials

Baumwolle, Baumwolle/Kunstfaser, Kunstfaser, Nomex
Cotton, Cotton/Synthetic blends, Synthetics, Nomex

Optionen/Options

Farbe, feuerhemmend
Color, fire retardant

J

Topfzentrierungen Cup spiders

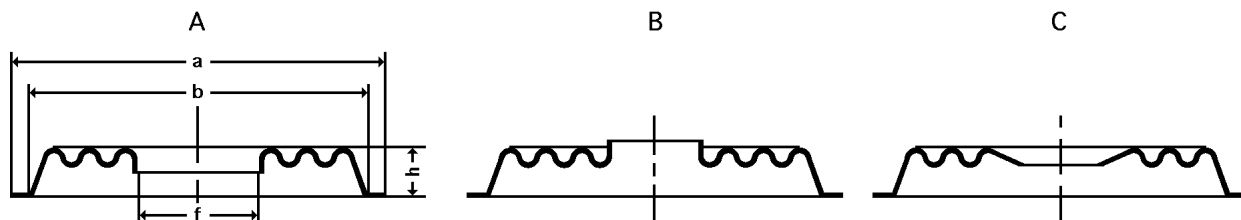

TYPE	Aussendurchmesser		Einspann- durchmesser	Halsdurchmesser		Höhe ohne Hals	Halsform
	Outside diameter			Clamping diameter	Neck diameter		
	a		b		f	h	
	mm	inches	mm	mm	inches	mm	
TZ 0430	71.0	2.80	64.5	20.2	0.795	7.0	A
TZ 0215	98.0	3.86	93.5	20.2	0.795	5.1	A
TZ 0386	53.0	2.09	49.0	20.3	0.799	7.1	A
TZ 0327	58.0	2.28	52.0	20.3	0.799	2.3	C
TZ 0187	61.0	2.40	57.5	20.3	0.799	4.5	A
TZ 0069	62.0	2.44	57.0	20.3	0.799	8.5	A
TZ 0210	63.0	2.48	59.0	20.3	0.799	8.5	A
TZ 0198	63.0	2.48	59.3	20.3	0.799	5.0	A
TZ 0374	65.0	2.56	56.0	20.3	0.799	2.5	C
TZ 0045	65.8	2.59	59.8	20.3	0.799	7.7	A
TZ 0045	65.8	2.59	59.8	20.3	0.799	7.0	A
TZ 0382	68.0	2.68	62.0	20.3	0.799	7.4	A
TZ 0197	74.0	2.91	70.4	20.3	0.799	6.6	A
TZ 0288	75.0	2.95	68.0	20.3	0.799	2.8	A
TZ 0089	76.0	2.99	72.0	20.3	0.799	4.0	A
TZ 0306	85.0	3.35	66.0	20.3	0.799	2.8	A
TZ 0088	94.0	3.70	87.8	20.3	0.799	4.3	A
TZ 0424	94.0	3.70	88.3	20.3	0.799	4.3	A
TZ 0437	94.0	3.70	88.3	20.3	0.799	4.3	A
TZ 0437	94.0	3.70	88.3	20.3	0.799	4.3	A
TZ 0126	98.0	3.86	93.5	20.3	0.799	4.0	A
TZ 0311	113.0	4.45	105.0	20.3	0.799	7.5	A
TZ 0184	58.2	2.29	52.5	20.4	0.803	4.0	A
TZ 0138	58.2	2.29	53.8	20.4	0.803	3.5	A
TZ 0078	58.2	2.29	54.4	20.4	0.803	3.3	A
TZ 0142	60.0	2.36	54.4	20.4	0.803	3.3	A
TZ 0417	61.0	2.40	56.0	20.4	0.803	4.5	A
TZ 0423	61.0	2.40	56.0	20.4	0.803	6.0	A
TZ 0417	61.0	2.40	56.0	20.4	0.803	4.5	A
TZ 0423	61.0	2.40	56.0	20.4	0.803	6.0	A
TZ 0417	63.0	2.48	56.0	20.4	0.803	4.5	A
TZ 0419	63.0	2.48	58.4	20.4	0.803	2.9	A
TZ 0399	63.0	2.48	59.0	20.4	0.803	3.3	A
TZ 0200	63.2	2.49	58.6	20.4	0.803	5.7	A

Materialien/Materials

Baumwolle, Baumwolle/Kunstfaser, Kunstfaser, Nomex
Cotton, Cotton/Synthetic blends, Synthetics, Nomex

Optionen/Options

Farbe, feuerhemmend
Color, fire retardant

J

Topfzentrierungen Cup spiders

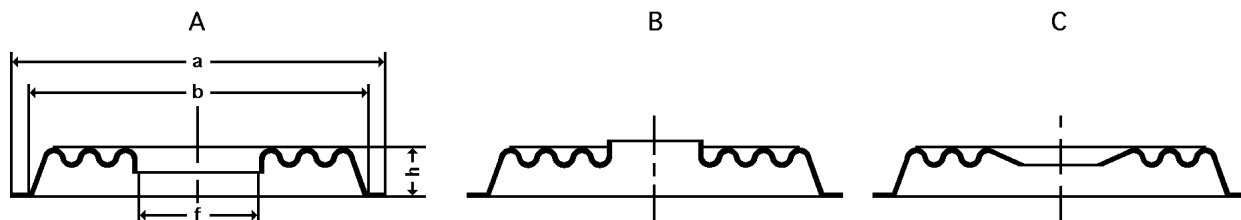

TYPE	Aussendurchmesser		Einspann- durchmesser	Halsdurchmesser		Höhe ohne Hals	Halsform
	Outside diameter			Clamping diameter	Neck diameter		
	a		b		f	h	
	mm	inches	mm	mm	inches	mm	
TZ 0082	63.2	2.49	58.6	20.4	0.803	5.7	A
TZ 0235	65.0	2.56	57.5	20.4	0.803	6.0	C
TZ 0252	54.0	2.13	51.0	20.5	0.807	7.5	A
TZ 0183	57.0	2.24	51.0	20.5	0.807	7.5	A
TZ 0377	57.8	2.28	52.8	20.5	0.807	2.8	A
TZ 0363	60.0	2.36	54.6	20.5	0.807	2.3	A
TZ 0390	60.0	2.36	54.6	20.5	0.807	4.8	A
TZ 0116	63.0	2.48	59.1	20.5	0.807	5.0	A
TZ 0201	65.0	2.56	59.0	20.5	0.807	5.2	C
TZ 0307	73.0	2.87	67.3	20.5	0.807	2.4	C
TZ 0468	74.0	2.91	63.0	20.5	0.807	6.9	A
TZ 0351	75.0	2.95	66.0	20.5	0.807	4.0	A
TZ 0076	90.0	3.54	78.0	20.5	0.807	9.3	C
TZ 0339	51.0	2.01	47.0	20.6	0.811	3.0	A
TZ 0388	57.8	2.28	52.8	20.7	0.815	4.8	A
TZ 0352	64.0	2.52	60.0	20.7	0.815	6.3	A
TZ 0351	72.0	2.83	66.0	20.7	0.815	4.0	A
TZ 0039	74.0	2.91	68.0	20.7	0.815	8.3	A
TZ 0043	78.0	3.07	72.0	20.7	0.815	4.0	A
TZ 0413	49.0	1.93	44.0	20.8	0.819	6.8	A
TZ 0438	49.0	1.93	44.0	20.8	0.819	6.8	A
TZ 0413	49.0	1.93	44.0	20.8	0.819	6.8	A
TZ 0365	94.0	3.70	88.3	20.8	0.819	4.3	A
TZ 0462	72.0	2.83	66.0	20.9	0.823	4.0	A
TZ 0366	92.2	3.63	86.0	20.9	0.823	5.4	A
TZ 0366	92.2	3.63	86.0	20.9	0.823	5.4	A
TZ 0366	92.2	3.63	86.0	20.9	0.823	5.4	2.0
TZ 0199	53.5	2.11	48.4	21.0	0.827	4.5	
TZ 0369	71.0	2.80	65.4	21.2	0.835	5.5	A
TZ 0369	71.0	2.80	65.4	21.2	0.835	6.5	A
TZ 0369	71.0	2.80	65.4	21.2	0.835	6.5	A
TZ 0202	60.0	2.36	52.0	21.4	0.843	2.6	A
TZ 0440	72.0	2.83	66.0	21.5	0.846	4.0	A
TZ 0263	65.0	2.56	59.0	22.8	0.896	4.0	C

Materialien/Materials

Baumwolle, Baumwolle/Kunstfaser, Kunstfaser, Nomex
Cotton, Cotton/Synthetic blends, Synthetics, Nomex

Optionen/Options

Farbe, feuerhemmend
Color, fire retardant

J

Topfzentrierungen Cup spiders

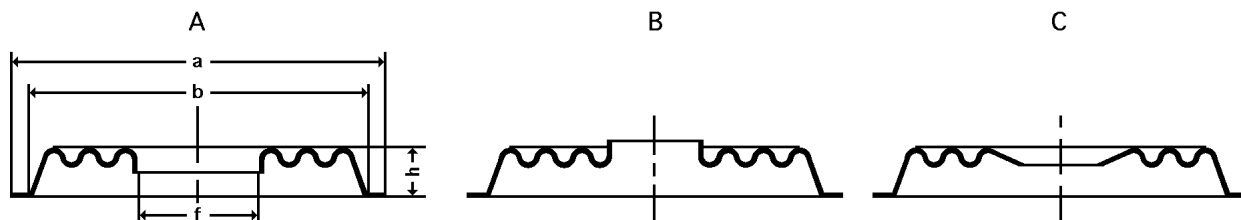

TYPE	Aussendurchmesser		Einspann- durchmesser	Halsdurchmesser		Höhe ohne Hals	Halsform
	Outside diameter			Clamping diameter	Neck diameter		
	a		b		f	h	

	mm	inches	mm	mm	inches	mm	
TZ 0062	65.5	2.58	59.0	22.8	0.896	5.0	C
TZ 0247	65.0	2.56	59.0	22.8	0.898	5.0	C
TZ 0294	65.0	2.56	59.0	23.0	0.906	5.0	C

25 mm ≤ Hals/Neck ø < 30 mm

TZ 0332	73.0	2.87	67.0	25.9	1.020	4.5	B
TZ 0264	65.0	2.56	60.0	26.0	1.024	5.0	C
TZ 0346	82.0	3.23	74.0	26.0	1.024	12.0	B
TZ 0262	84.0	3.31	76.4	26.0	1.024	4.0	A
TZ 0239	62.0	2.44	56.0	26.2	1.031	4.7	A
TZ 0249	67.0	2.64	59.8	26.2	1.031	4.7	A
TZ 0242	72.0	2.83	67.0	26.4	1.039	5.8	A
TZ 0321	73.0	2.87	68.4	26.4	1.039	4.5	C
TZ 0458	73.0	2.87	68.4	26.4	1.039	4.7	C
TZ 0459	73.0	2.87	68.4	26.4	1.039	4.7	C
TZ 0460	73.0	2.87	68.4	26.4	1.039	4.7	C
TZ 0077	114.0	4.49	107.0	26.4	1.039	6.0	C
TZ 0350	115.0	4.53	107.2	26.4	1.039	9.5	A
TZ 0066	85.0	3.35	78.0	26.5	1.043	9.0	A
TZ 0052	81.5	3.21	75.5	26.6	1.047	6.4	A
TZ 0075	81.5	3.21	75.5	26.6	1.047	6.9	A
TZ 0293	86.0	3.39	75.2	26.6	1.047	12.0	A
TZ 0118	98.0	3.86	93.7	26.6	1.047	3.8	A
TZ 0131	98.0	3.86	93.7	26.6	1.047	3.8	A
TZ 0091	110.0	4.33	104.1	26.6	1.047	6.0	A
TZ 0392	60.0	2.36	54.6	26.7	1.051	4.9	A
TZ 0379	64.0	2.52	60.0	26.7	1.051	6.3	A
TZ 0289	75.0	2.95	69.0	26.7	1.051	6.1	A
TZ 0300	75.0	2.95	69.0	26.7	1.051	6.1	A
TZ 0334	75.0	2.95	69.0	26.7	1.051	6.2	A
TZ 0348	75.0	2.95	69.3	26.7	1.051	6.1	A
TZ 0325	82.0	3.23	74.4	26.7	1.051	10.0	A
TZ 0343	94.0	3.70	87.2	26.7	1.051	4.7	A

Materialien/Materials

Baumwolle, Baumwolle/Kunstfaser, Kunstfaser, Nomex
Cotton, Cotton/Synthetic blends, Synthetics, Nomex

Optionen/Options

Farbe, feuerhemmend
Color, fire retardant

J

Topfzentrierungen Cup spiders

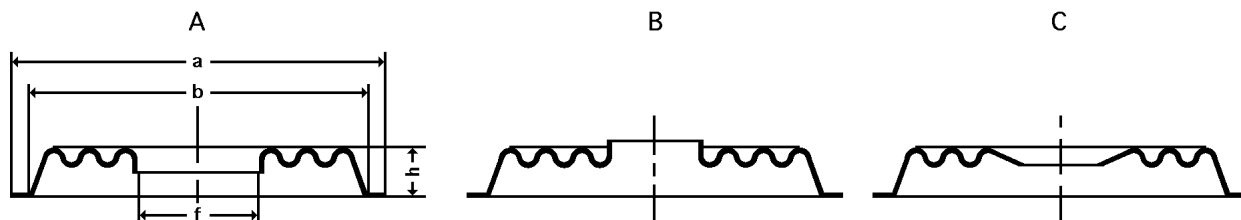

TYPE	Aussendurchmesser		Einspann- durchmesser	Halsdurchmesser		Höhe ohne Hals	Halsform
	Outside diameter			Clamping diameter	Neck diameter		
	a		b		f	h	
	mm	inches	mm	mm	inches	mm	
TZ 0343	96.0	3.78	87.2	26.7	1.051	4.7	A
TZ 0435	62.5	2.46	57.2	26.8	1.055	5.7	A
TZ 0471	67.0	2.64	67.0	26.8	1.055	8.3	A
TZ 0385	71.0	2.80	66.0	26.8	1.055	6.0	A
TZ 0299	73.0	2.87	66.8	26.8	1.055	8.3	A
TZ 0323	73.0	2.87	66.8	26.8	1.055	8.3	A
TZ 0305	88.0	3.46	79.0	26.8	1.055	10.0	A
TZ 0367	94.5	3.72	86.0	26.8	1.055	9.0	A
TZ 0324	95.0	3.74	88.0	26.8	1.055	10.0	A
TZ 0316	95.0	3.74	89.0	26.8	1.055	10.0	A
TZ 0344	96.0	3.78	8702.0	26.8	1.055	3.3	C
TZ 0044	97.8	3.85	91.8	26.8	1.055	5.9	A
TZ 0317	113.0	4.45	105.0	26.8	1.055	7.2	A
TZ 0318	113.0	4.45	105.0	26.8	1.055	7.0	A
TZ 0368	115.0	4.53	108.0	26.8	1.055	9.5	A
TZ 0406	130.0	5.12	144.8	26.8	1.055	5.2	A
TZ 0384	92.0	3.62	83.0	26.9	1.059	3.8	A
TZ 0467	85.0	3.35	77.4	27.0	1.063	7.4	A
TZ 0487	85.0	3.35	77.4	27.0	1.063	7.6 2.6	A
TZ 0364	85.0	3.35	78.0	27.0	1.063	9.0	A
TZ 0421	95.0	3.74	88.0	27.0	1.063	6.2	C
TZ 0457	113.0	4.45	104.0	27.1	1.067	3.8	A
TZ 0469	93.0	3.66	86.0	27.2	1.071	3.8	A
TZ 0276	110.0	4.33	99.6	27.2	1.071	3.9	A
TZ 0268	114.0	4.49	107.0	27.2	1.071	6.0	A
TZ 0429	95.0	3.74	88.0	27.3	1.075	5.8	A
TZ 0243	80.0	3.15	73.0	27.4	1.079	4.5	A
TZ 0297	101.0	3.98	93.0	28.0	1.102	4.0	C
TZ 0286	108.0	4.25	100.6	29.3	1.154	6.5	A

30 mm ≤ Hals/Neck ø < 35 mm

TZ 0127	125.0	4.92	109.0	30.7	1.209	4.5	A
TZ 0050	97.8	3.85	91.8	31.5	1.240	6.3	A

Materialien/Materials

Baumwolle, Baumwolle/Kunstfaser, Kunstfaser, Nomex
Cotton, Cotton/Synthetic blends, Synthetics, Nomex

Optionen/Options

Farbe, feuerhemmend
Color, fire retardant

J

Topfzentrierungen Cup spiders

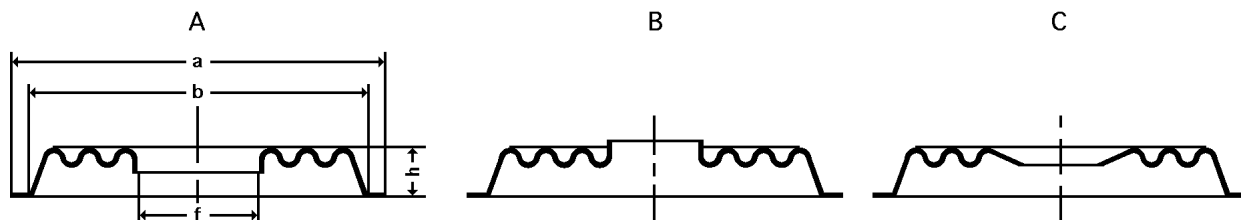

TYPE	Aussendurchmesser		Einspann- durchmesser	Halsdurchmesser		Höhe ohne Hals	Halsform
	Outside diameter			Clamping diameter	Neck diameter		
	a		b		f	h	

	mm	inches	mm	mm	inches	mm	
TZ 0278	93.0	3.66	82.8	31.9	1.256	8.0	A
TZ 0223	107.0	4.21	96.6	33.0	1.299	8.9	A
TZ 0230	107.0	4.21	96.6	33.0	1.299	8.9	A

35 mm ≤ Hals/Neck ø < 40 mm

TZ 0296	110.0	4.33	98.0	36.6	1.441	10.5	A
TZ 0165	120.0	4.72	112.0	38.5	1.516	7.5	C
TZ 0270	114.0	4.49	102.0	39.0	1.535	4.5	A
TZ 0287	124.0	4.88	107.5	39.0	1.535	4.5	C
TZ 0360	130.0	5.12	120.0	39.0	1.535	6.0	C
TZ 0397	114.0	4.49	106.8	39.2	1.543	6.0	C
TZ 0395	115.0	4.53	106.0	39.2	1.543	11.0	A
TZ 0381	124.0	4.88	110.9	39.2	1.543	2.8	A
TZ 0322	130.0	5.12	120.0	39.2	1.543	5.8	A
TZ 0404	126.0	4.96	114.2	39.3	1.547	7.5	A
TZ 0370	135.0	5.31	130.0	39.3	1.547	7.5	A
TZ 0315	95.0	3.74	89.0	39.4	1.551	11.0	A
TZ 0357	122.0	4.80	110.0	39.4	1.551	10.5	A
TZ 0405	104.0	4.09	94.0	39.5	1.555	5.9	A
TZ 0463	108.0	4.25	94.3	39.5	1.555	6.6	A
TZ 0308	120.0	4.72	110.0	39.5	1.555	16.0	A
TZ 0269	114.0	4.49	107.0	39.6	1.559	6.0	A

40 mm ≤ Hals/Neck ø < 50 mm

TZ 0376	130.0	5.12	118.0	45.0	1.772	4.0	A
---------	-------	------	-------	------	-------	-----	---

Hals/Neck ø ≥ 50mm

TZ 0383	135.0	5.31	130.0	52.3	2.059	9.8	A
TZ 0372	142.6	5.61	132.6	52.6	2.071	8.0	A
TZ 0521	117.0	4.61	108.0	63.3	2.492	3.4 2.9	
TZ 0304	150.0	5.91	140.0	64.3	2.531	4.8	A
TZ 0292	140.0	5.51	131.8	64.8	2.551	10.0	A
TZ 0551	108.0	4.25	100.9	268.0	10.551	52.0 2.0	

Materialien/Materials

Baumwolle, Baumwolle/Kunstfaser, Kunstfaser, Nomex
Cotton, Cotton/Synthetic blends, Synthetics, Nomex

Optionen/Options

Farbe, feuerhemmend
Color, fire retardant

K

Abdeckkalotten, rund Dust caps, round

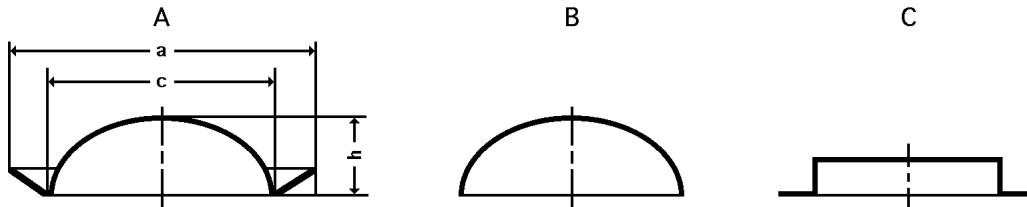

TYPE	Aussendurchmesser Outside diameter	Einspann- durchmesser Clamping diameter	Höhe Height	Form Form
	a	b	h	
	mm inches	mm	mm	

AKR 0011	13.7	0.54	12.1	1.5	C
AKR 0031	18.0	0.71	14.5	4.2	A
AKR 0015	18.3	0.72	16.3	2.0	C
AKR 0032	18.5	0.73	15.5	3.1	A
AKR 0021	18.7	0.74	17.3	2.0	C
AKR 0011	19.4	0.76	16.5	1.9	A
AKR 0020	20.0	0.79	16.0	2.7	A
AKR 0014	20.0	0.79	17.5	3.2	A
AKR 0009	20.3	0.80	19.9	2.0	C
AKR 0028	20.4	0.80	19.6	10.1	B
AKR 0005	21.0	0.83	19.3	3.0	C
AKR 0012	21.0	0.83	20.3	3.0	C
AKR 0004	21.4	0.84		3.0	C
AKR 0016	22.5	0.89	20.9	4.5	C
AKR 0017	22.5	0.89	21.3	4.5	C
AKR 0030	23.0	0.91	20.5	3.5	A
AKR 0056	24.0	0.94		0.9	B
AKR 0025	25.0	0.98		5.3	A
AKR 0029	25.5	1.00	21.9	8.5	A
AKR 0047	26.0	1.02		10.0	B
AKR 0001	26.4	1.04	21.7	4.5	A
AKR 0024	29.0	1.14	25.4	9.0	A
AKR 0008	30.0	1.18	25.0	2.3	A
AKR 0006	30.3	1.19	27.0	3.8	A
AKR 0002	31.0	1.22	27.0	4.0	A
AKR 0010	31.3	1.23	30.9	2.0	C
AKR 0044	31.5	1.24	29.0	7.0	A
AKR 0013	31.7	1.25		19.3	A
AKR 0018	33.0	1.30	29.0	7.0	A
AKR 0036	34.0	1.34	31.0	5.7	A
AKR 0050	35.0	1.38		2.0	A

Materialien/Materials

Zellulose, Plastik, Metall, Gewebe
Cellulose, plastic, metal, fabric

Optionen/Options

Luftgetrocknet, hartverpresst, Farbe, beschriftet
Air dried, pressed, color, labeled

K

Abdeckkalotten, rund Dust caps, round

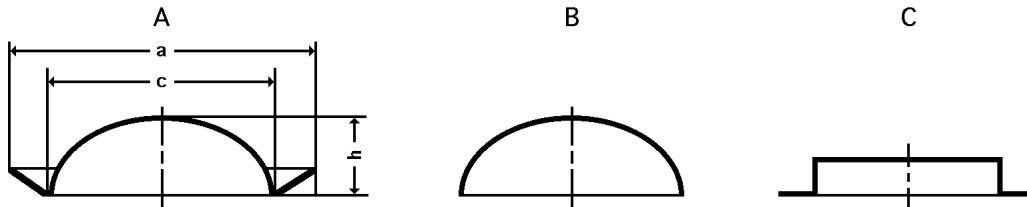

TYPE	Aussendurchmesser		Einspann- durchmesser	Höhe	Form			
	Outside diameter					Clamping diameter	Height	Form
	a							
mm	inches	b	h	mm				
AKR 0019	37.0	1.46	33.0	8.5	A			
AKR 0003	38.5	1.52	34.0	6.0	A			
AKR 0038	38.5	1.52	34.0	6.0	A			
AKR 0002	38.5	1.52	34.0	6.0	A			
AKR 0055	39.0	1.54		2.7	B			
AKR 0045	39.0	1.54	38.0	5.0	A			
AKR 0007	39.0	1.54	38.0	5.5	A			
AKR 0023	40.0	1.57		6.0	B			
AKR 0039	41.0	1.61	37.0	10.5	A			
AKR 0-35	41.0	1.61	38.0	5.5	A			
AKR 0035	41.0	1.61	38.0	5.5	A			
AKR 0048	42.0	1.65		12.5	B			
AKR 0040	45.0	1.77		3.3	B			
AKR 0027	46.0	1.81	42.0	16.0	A			
AKR 0057	48.0	1.89		3.8	B			
AKR 0051	51.1	2.01		10.7	A			
AKR 0064	51.5	2.03	48.0	13.0	A			
AKR 0069	55.0	2.17	49.0	10.8	A			
AKR 0043	56.5	2.22	50.0	5.5	A			
AKR 0053	59.0	2.32	55.2	8.5	B			
AKR 0046	60.0	2.36		6.0	B			
AKR 0049	60.0	2.36		6.0	B			
AKR 0034	63.0	2.48	56.0	17.8	A			
AKR 0026	64.0	2.52	60.0	6.0	B			
AKR 0061	70.0	2.76		6.4	B			
AKR 0054	71.5	2.81		13.0	B			
AKR 6052	80.0	3.15		10.2	B			
AKR 5985	85.0	3.35	8.2	8.0	A			
AKR 0085	85.0	3.35	82.0	8.0	A			
AKR 0052	87.0	3.43	82.0	10.0	A			
AKR 0063	92.0	3.62	84.0	15.0	A			

Materialien/Materials

Zellulose, Plastik, Metall, Gewebe
Cellulose, plastic, metal, fabric

Optionen/Options

Luftgetrocknet, hartverpresst, Farbe, beschriftet
Air dried, pressed, color, labeled



Abdeckkalotten, oval Dust caps, oval

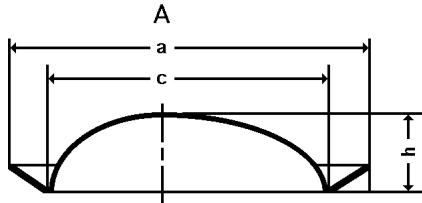

TYPE	Aussendurchmesser Outside diameter a mm inches	Einspanndurchmesser Clamping diameter b mm	Höhe Height h mm	Form
------	--	---	---------------------------	------

AKO 0033	28.4 x 22.2 1.12 x 0.87	24.4 x 19.6	2.0	
AKO 0042	32.7 x 24.5 1.29 x 0.96	25.0 x 20.6	2.7	
AKO 0041	32.7 x 24.5 1.29 x 0.96	25.0 x 20.6	3.7	
AKO 0021	34.4 x 27.0 1.35 x 1.06	30.0 x 25.0	5.0	
AKO 0007	35.0 x 28.6 1.38 x 1.13	30.0 x 20.4	2.5	
AKO 0022	36.0 x 29.6 1.42 x 1.17	31.3 x 27.1	5.4	
AKO 0015	38.6 x 33.8 1.52 x 1.33	36.0 x 32.0	3.3	
AKO 0037	41.5 x 27.5 1.63 x 1.08	36.5 x 25.0	4.6	

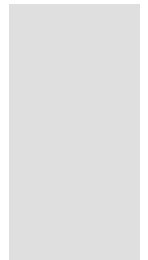
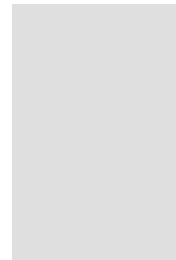

Materialien/Materials

Zellulose, Plastik, Metall, Gewebe
Cellulose, plastic, metal, fabric

Optionen/Options

Luftgetrocknet, hartverpresst, Farbe, beschriftet
Air dried, pressed, color, labeled